

en

# Exploded drawings

## Electric and Gas Combisteamer Gold

European CE-Version

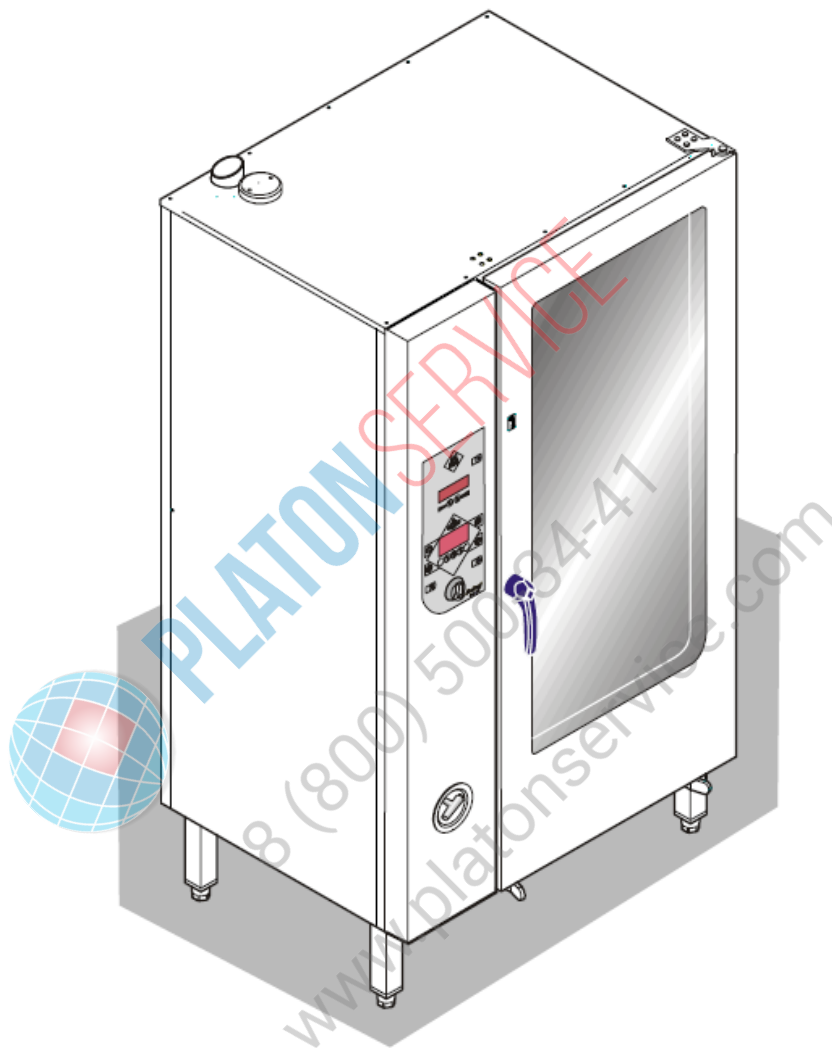

Model	Serial-No. / date	
	from	thru
<b>Software:</b>	Version 4.00	
HansDampf 6.x, right hinged	12212149 / Oct. 2012	-
HansDampf 6.x, left hinged	12212288 / Nov. 2012	-
HansDampf 10.x right hinged	12211027 / Oct. 2012	-
HansDampf 10.x left hinged	12213195 / Nov. 2012	-
HansDampf 20.x right hinged	12200172 / Jan. 2007	-
HansDampf 20.x left hinged	12200172 / Jan. 2007	-

2013/01/07 SEV/KA

## New cabinet door and door gasket for 6.x & 10.x

From October 2012 the cabinet door incl. door lock and gasket has been changed stepwise.

**Furthermore, the door gasket has been changed. The new one has the same dimensions, but because of the style the gasket is not downward compatible.**

Also door lock and collecting tray do not fit into old door types!

Unit type	Previous door seal no.	New door seal no.
6.x	#211094	#10012489
10.x	#211095	#10012490



**PLATON SERVICE**  
8 (800) 500-34-47  
[www.platonservice.com](http://www.platonservice.com)

## Contents

New cabinet door and door gasket for 6.x & 10.x.....	2
Front panel HD6.x Gold.....	5
Front panel HD10.x Gold.....	6
Electric assembly 3NPE 400V HD6.1.....	7
Electric assembly 3NPE 400V HD6.2.....	8
Electric assembly 3NPE 400V HD10.1.....	9
Electric assembly 3NPE 400V HD10.2.....	10
Gas assembly HD6.1.....	11
Gas assembly HD6.2.....	12
Gas assembly HD10.1.....	13
Gas assembly HD10.2.....	14
Core temperature probe HD6.x & HD10.x.....	15
Tube carrier box & handshower HD6.x & HD10.x Electric.....	16
Tube carrier box & handshower 6.x & 10.x Gas.....	17
Water assembly 50Hz HD6.x & HD10.x.....	18
Chassis HD6.x Electric.....	19
Chassis HD10.x Electric.....	20
Chassis HD6.x Gas.....	21
Chassis HD10.x Gas.....	22
Chassis door area HD6.x, right hinged (Electric).....	23
Chassis door area HD6.x, left hinged (Electric).....	24
Chassis door area HD10.x, right hinged (Electric).....	25
Chassis door area HD10.x, left hinged (Electric).....	26
Chassis door area HD6.x, right hinged (Gas).....	27
Chassis door area HD6.x, left hinged (Gas).....	28
Chassis door area HD10.x, right hinged (Gas).....	29
Chassis door area HD10.x, left hinged (Gas).....	30
Front panel HD20.x Gold.....	32
Electric assembly 3NPEAC 400V HD20.1.....	33
Electric assembly 3NPEAC 400V HD20.2.....	34
Gas assembly HD20.1.....	35
Gas assembly HD20.2.....	36
Core temperature probe HD20.x.....	37
Tube carrier box & handshower HD20.x (Electric).....	38
Tube carrier box & handshower HD20.x Gas.....	39
Water assembly 50Hz HD20.x.....	40
Chassis HD20.x (Electric).....	41
Chassis HD20.x (Gas).....	42
Chassis door area HD20.x, right hinged (Electric).....	43
Chassis door area HD20.x, left hand hinged (Electric).....	44
Chassis door area HD20.x, right hinged (Gas).....	45
Chassis door area HD20.x, left hand hinged.....	46

## Exploded drawings 6.x & 10.x

Electric & Gas



**PLATON SERVICE**

8 (800) 500-34-41

[www.platonservice.com](http://www.platonservice.com)

## Front panel HD6.x Gold

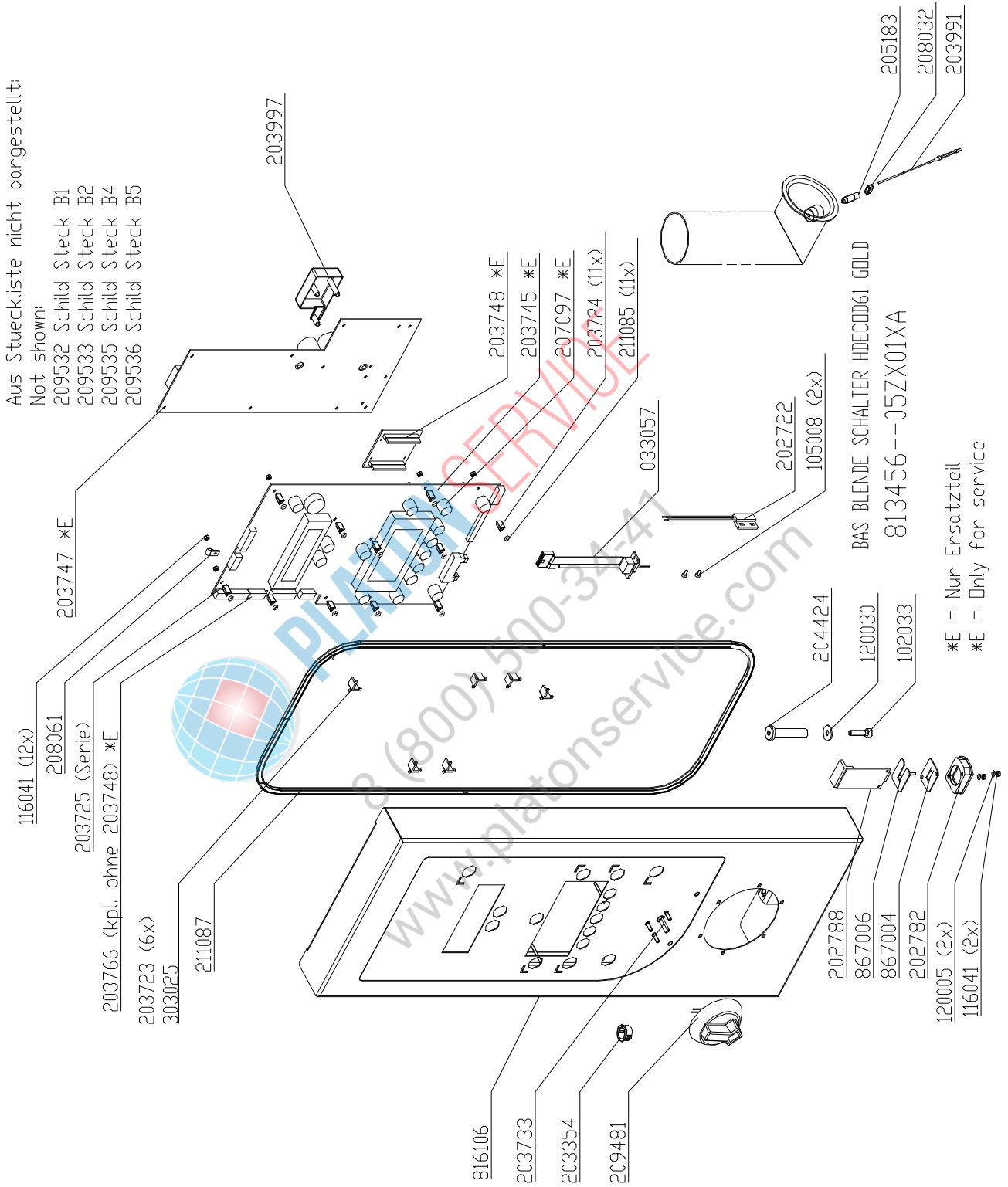

## Front panel HD10.x Gold

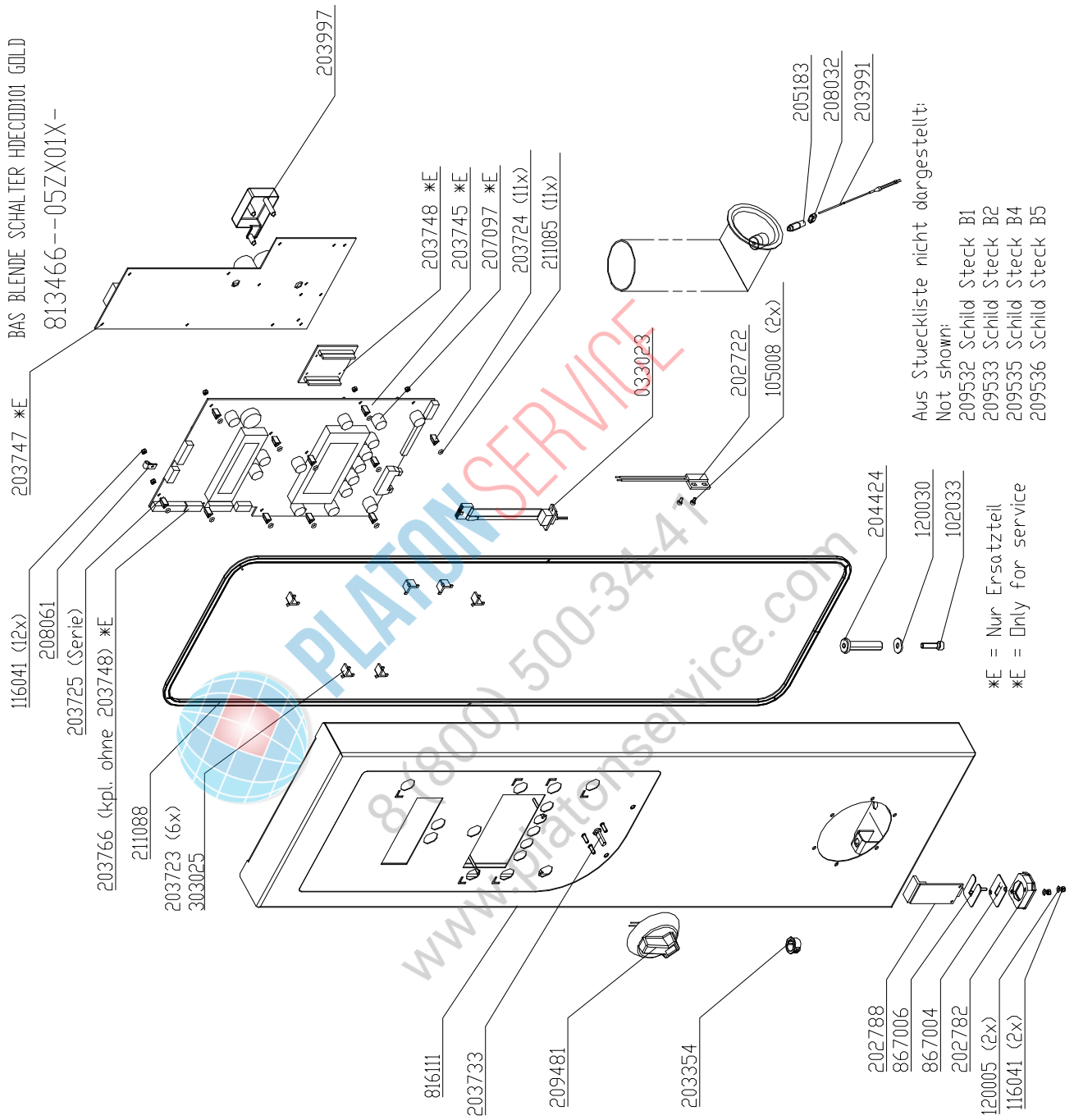

## Electric assembly 3NPE 400V HD6.1

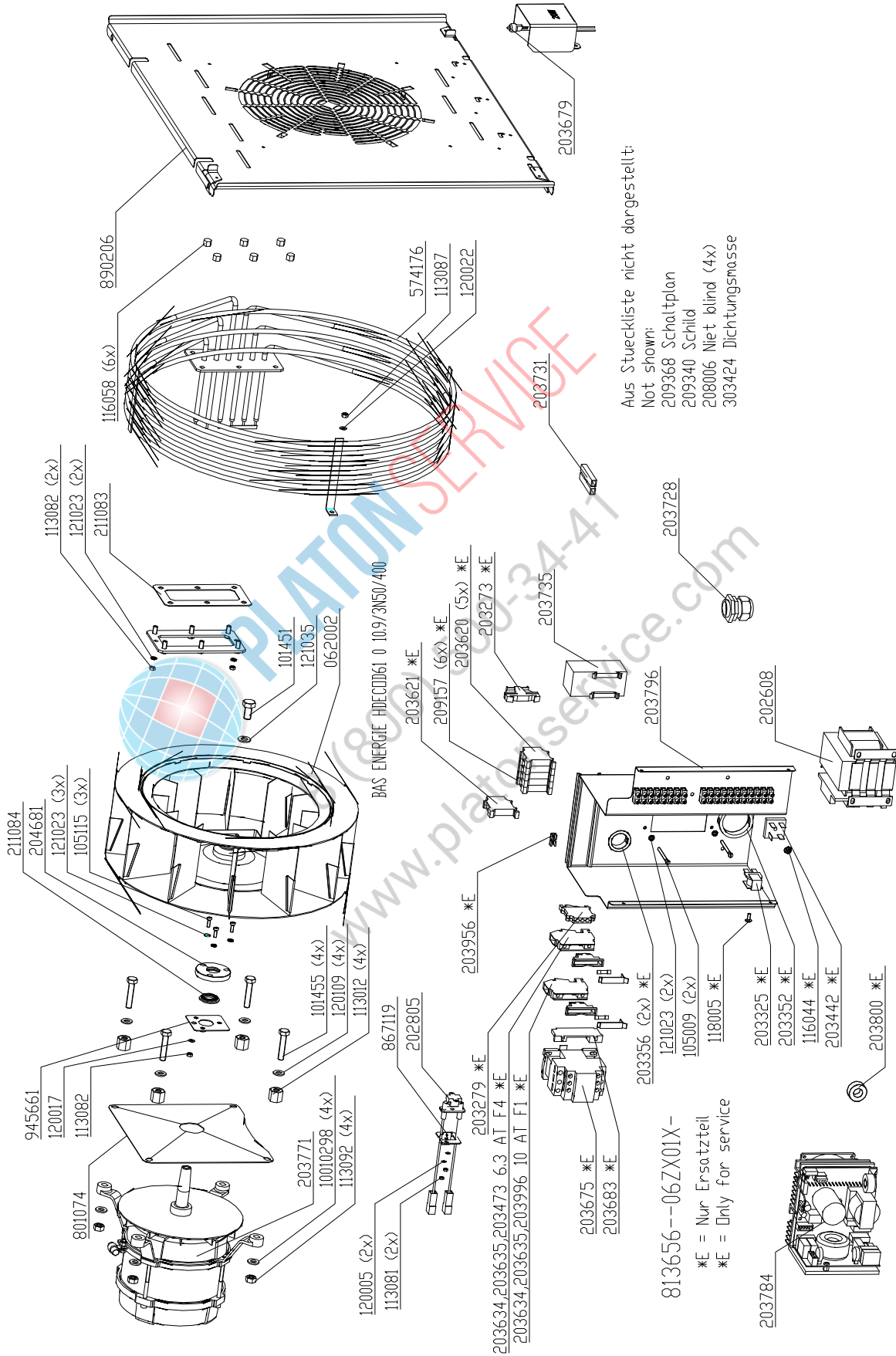

Aus Stueckliste nicht dargestellt:  
 Not shown:  
 209368 Schaltplan  
 209340 Schild  
 208006 Niet-blind (4x)  
 303424 Dichtungsmasse

813656--06ZX01X-  
 \*E = Nur Ersatzteil  
 \*E = Only for service

## Electric assembly 3NPE 400V HD6.2

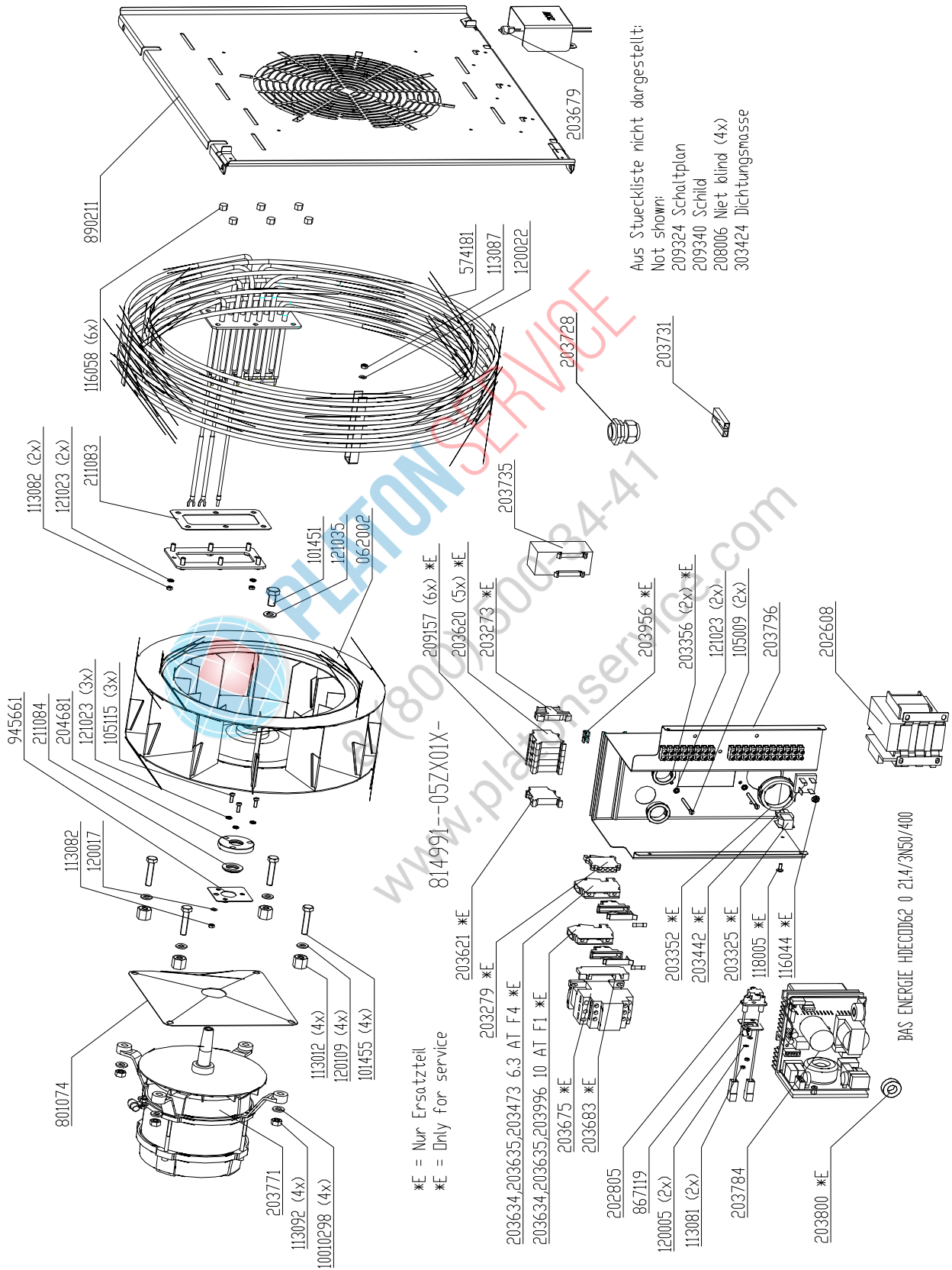



## Electric assembly 3NPE 400V HD10.1

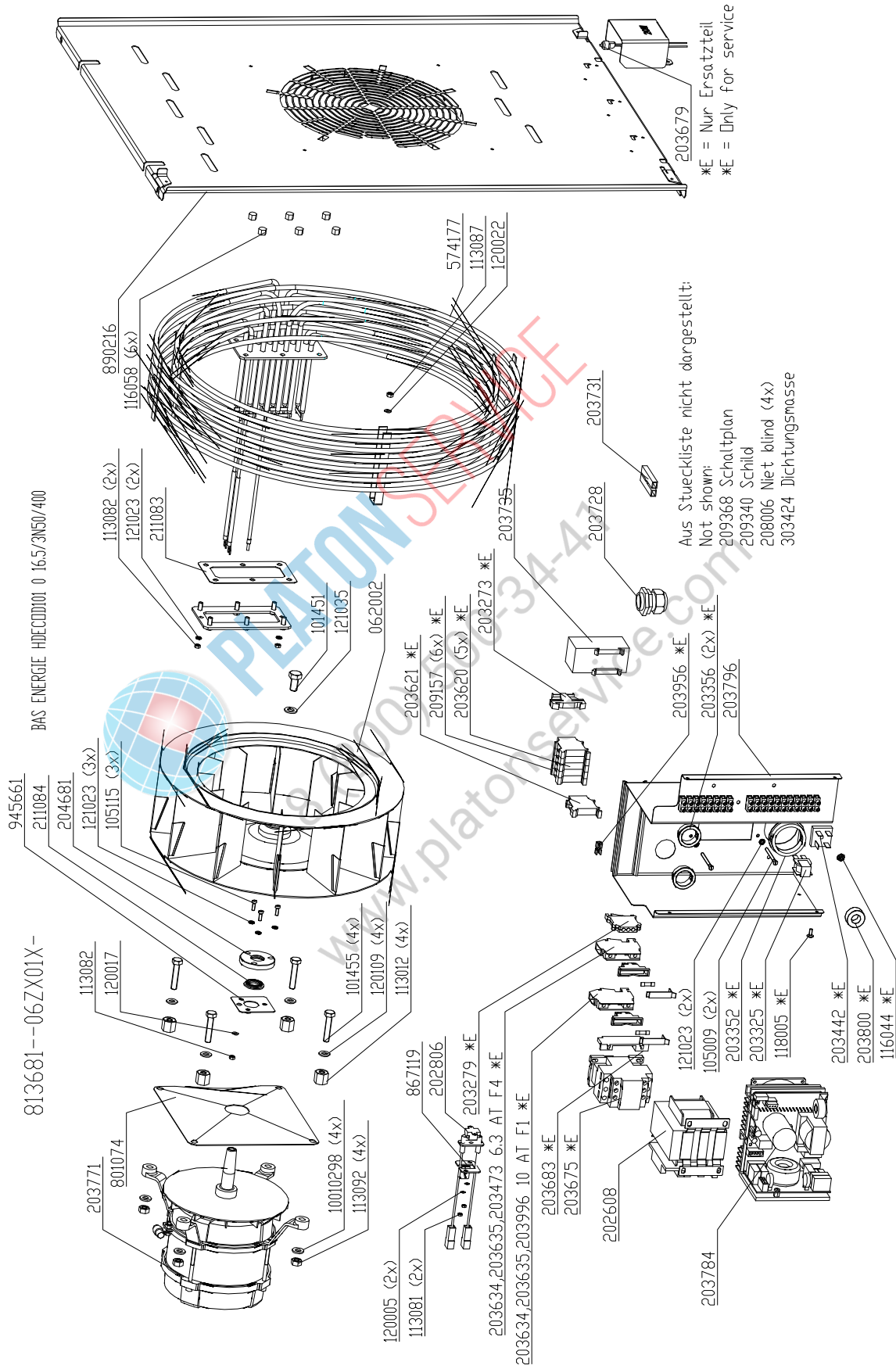

## Electric assembly 3NPE 400V HD10.2

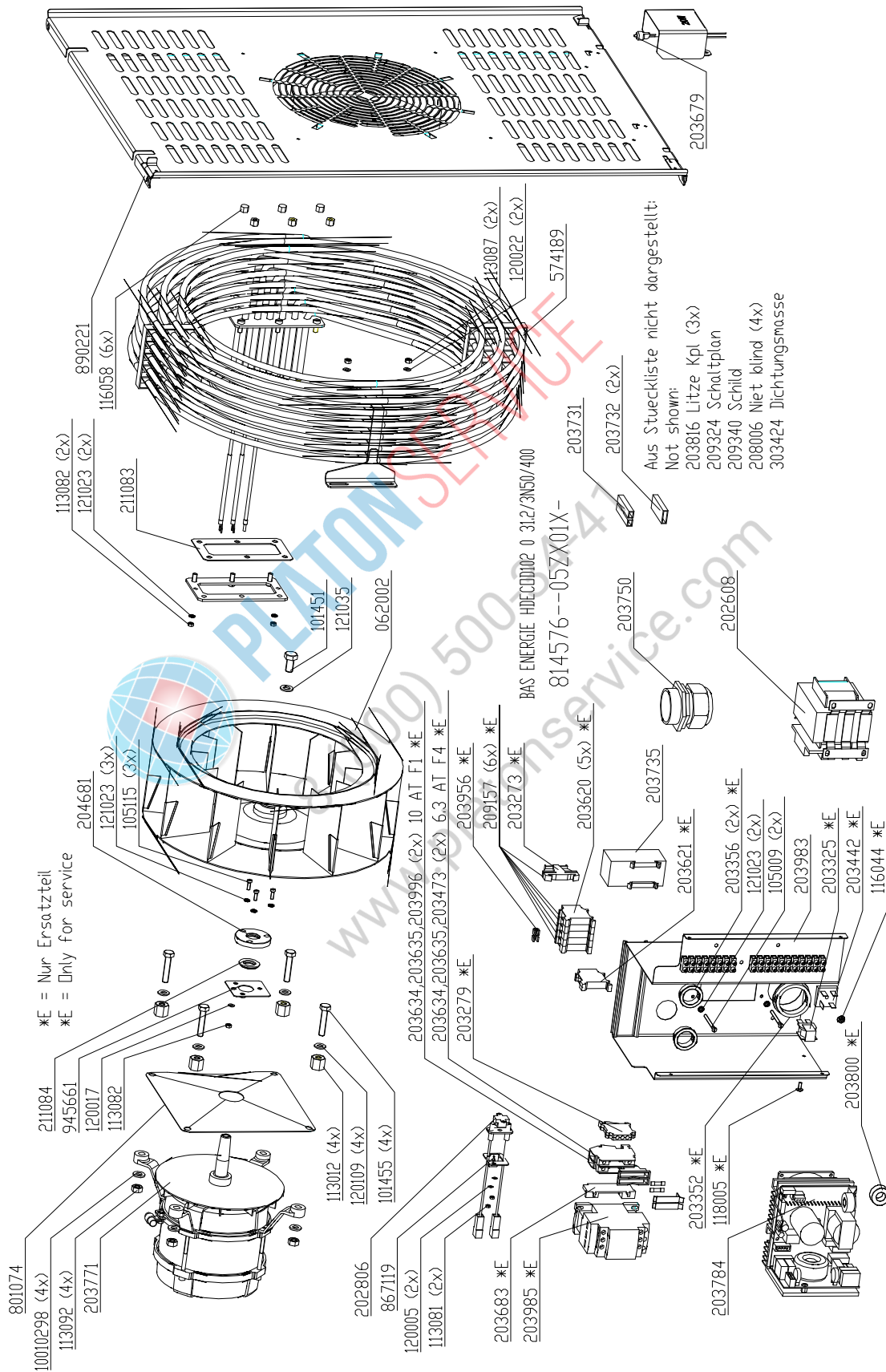

# Gas assembly HD6.1

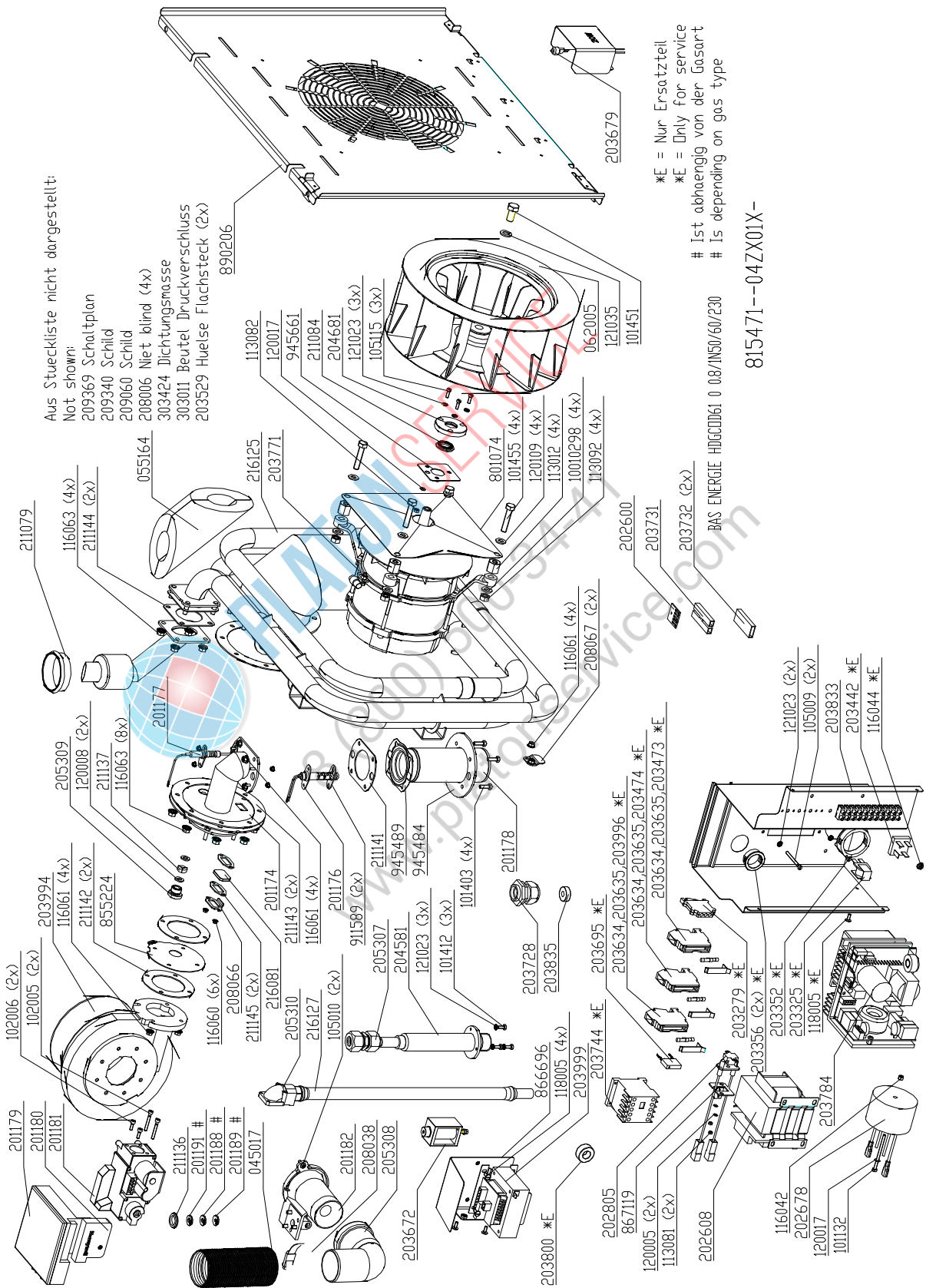





# Gas assembly HD10.1

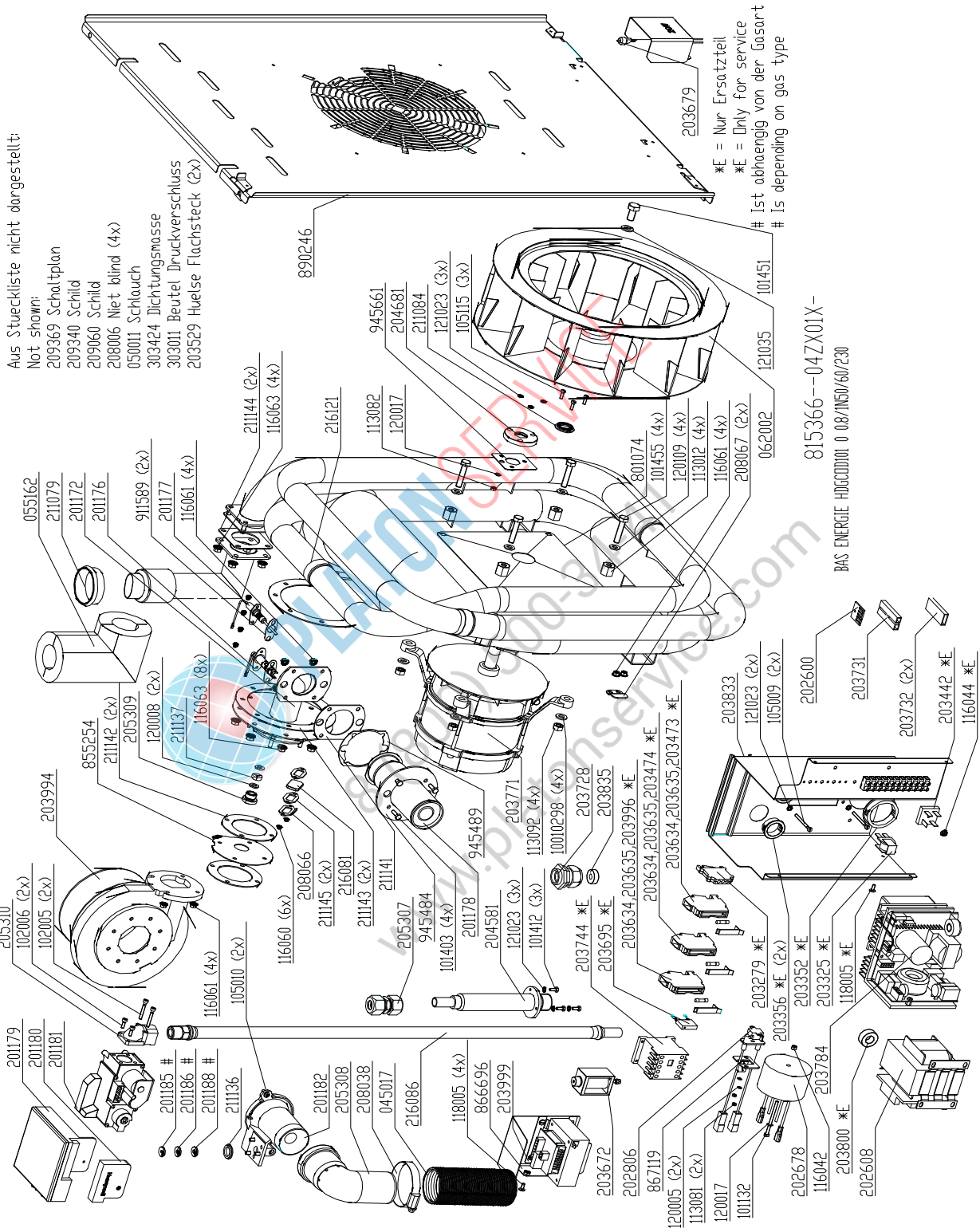

## Gas assembly HD10.2

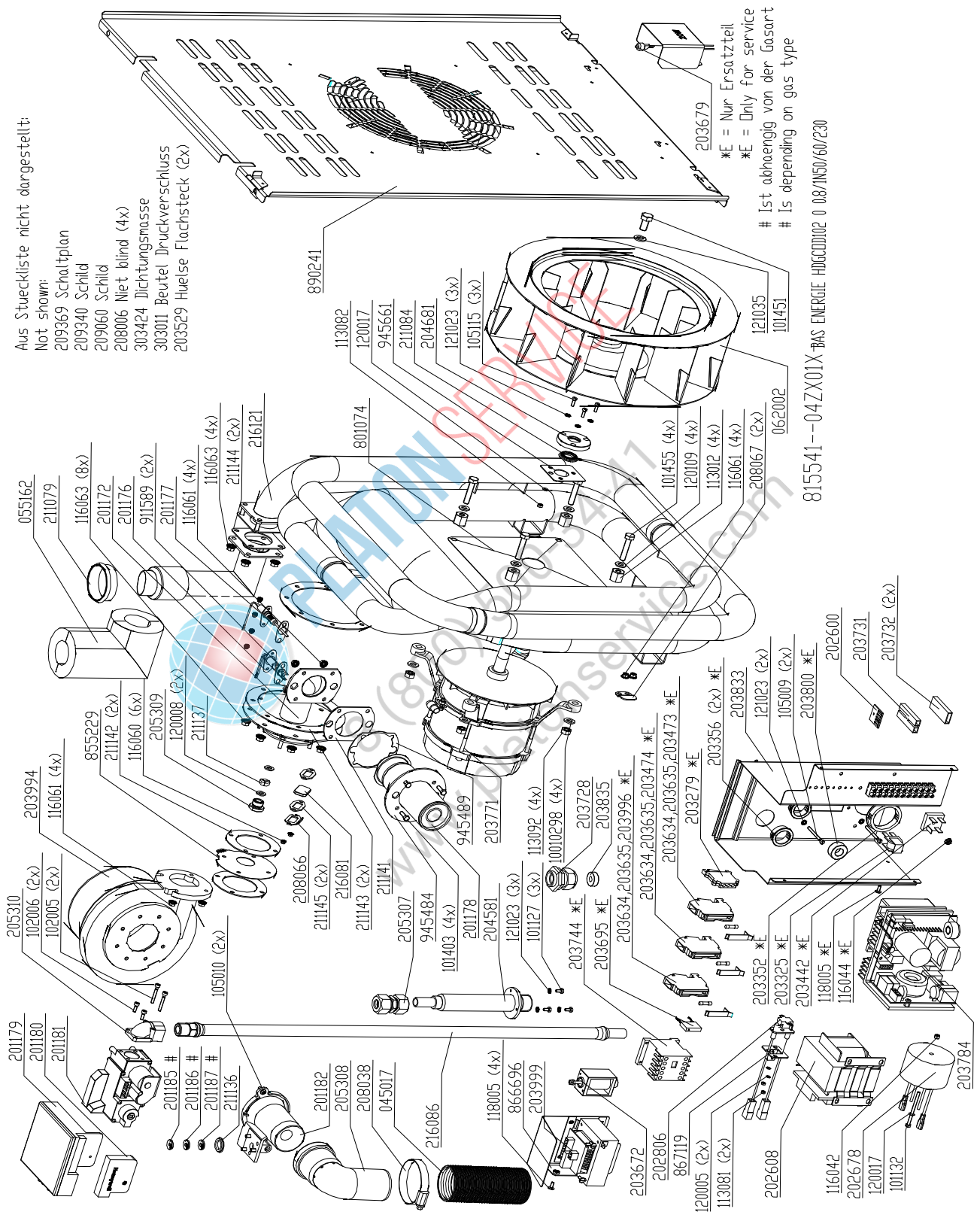

Aus Stueckliste nicht dargestellt:  
Not shown:  
209369 Schaltplan  
209340 Schild  
209060 Schild  
208006 Niet blind (4x)  
303424 Dichtungsmasse  
303011 Beutel Druckverschluss  
203529 Huelse Flachsteck (2x)

### Core temperature probe HD6.x & HD10.x

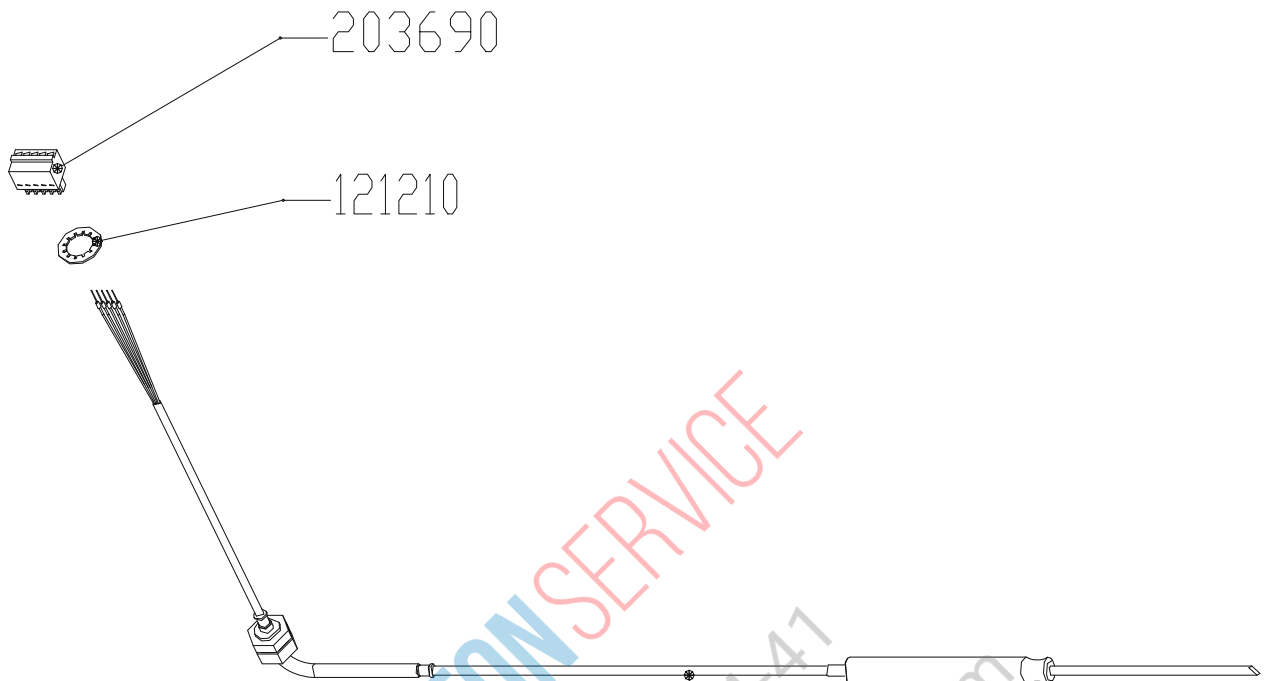

BAS FUEHLER HDEC0061 GOLD

813601--00ZE01X-



PLATON SERVICE  
8 (800) 500-34-47  
www.platonservice.com

## Tube carrier box & handshower HD6.x & HD10.x Electric

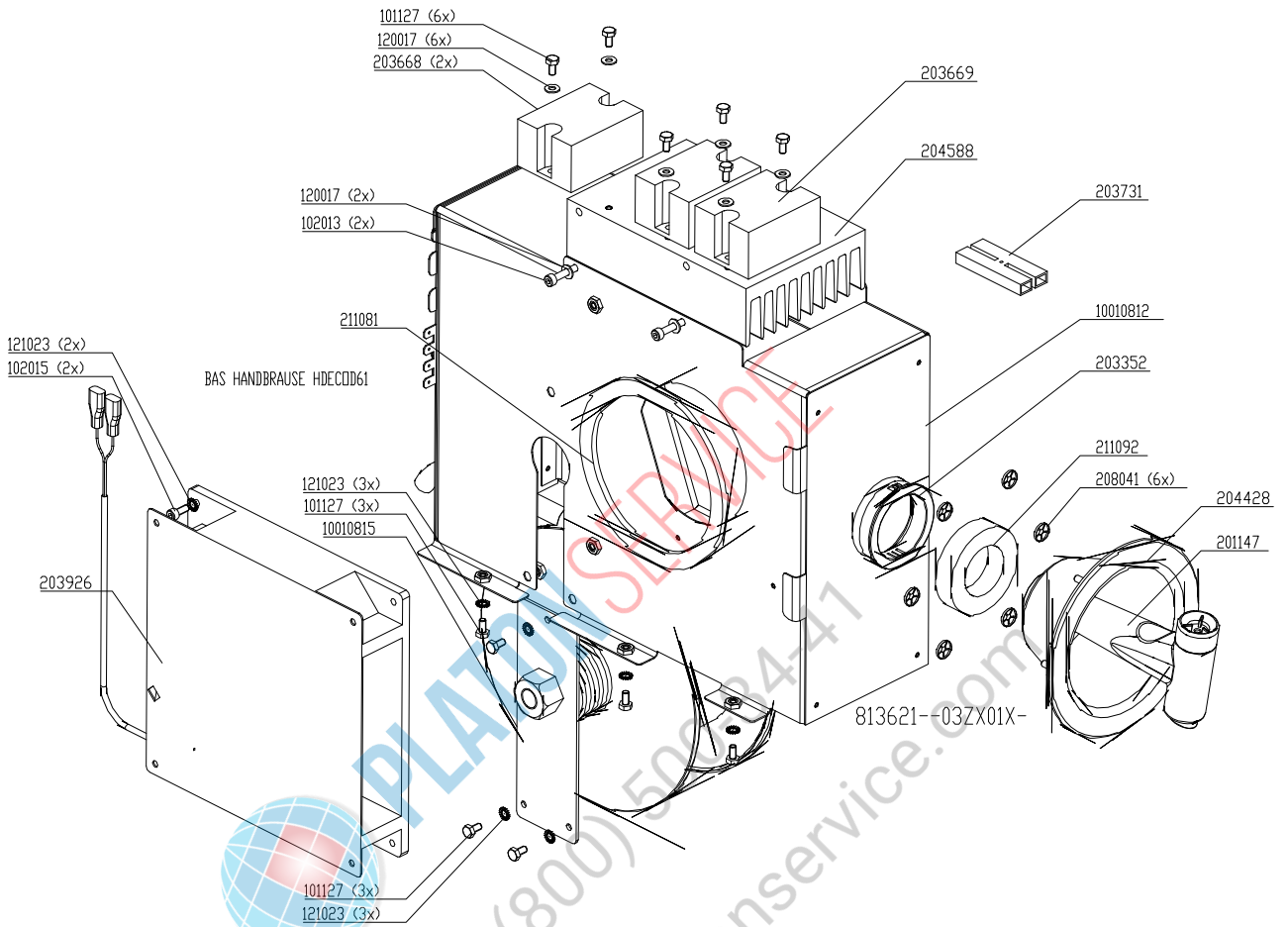



## Tube carrier box & handshower 6.x & 10.x Gas

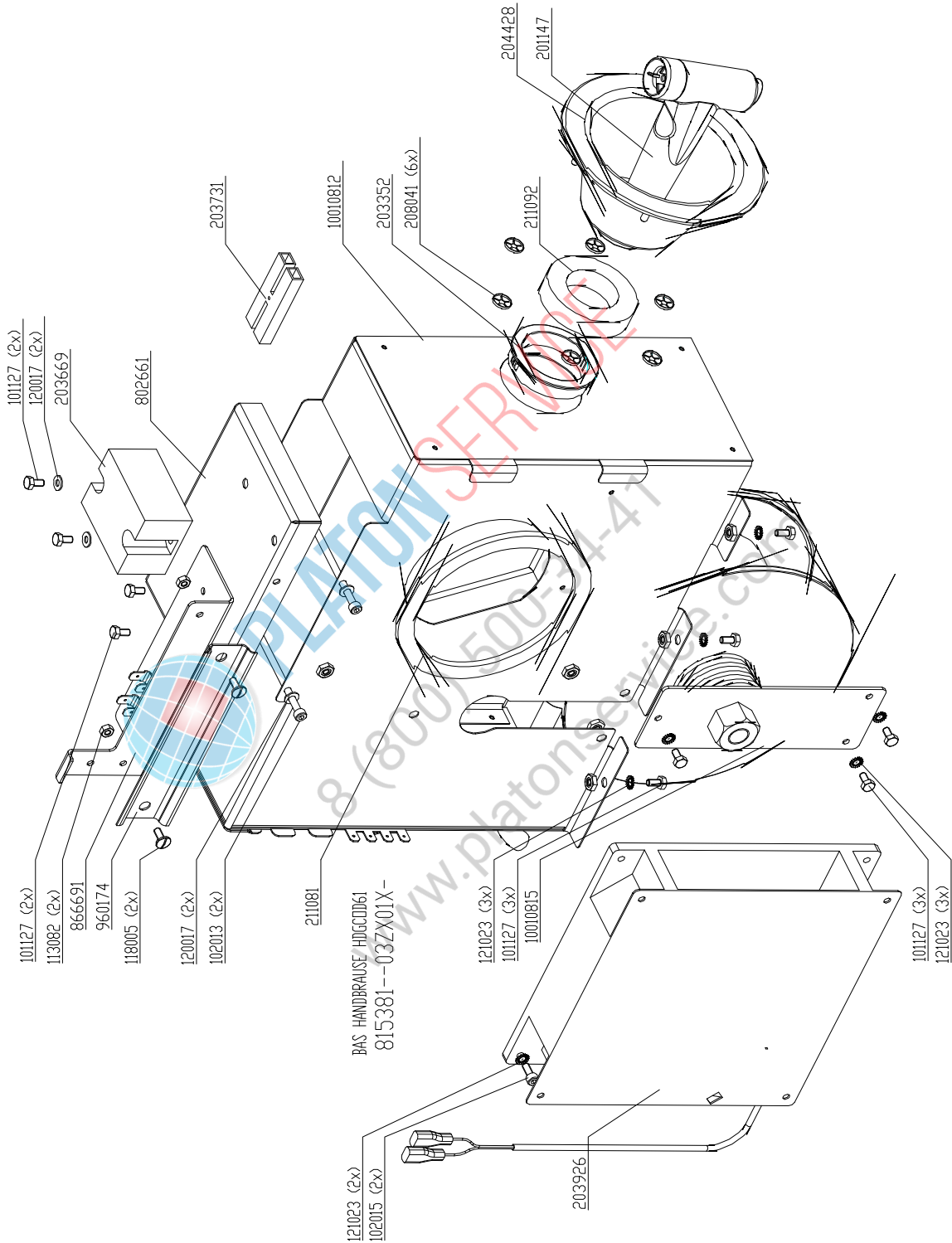

## Water assembly 50Hz HD6.x & HD10.x

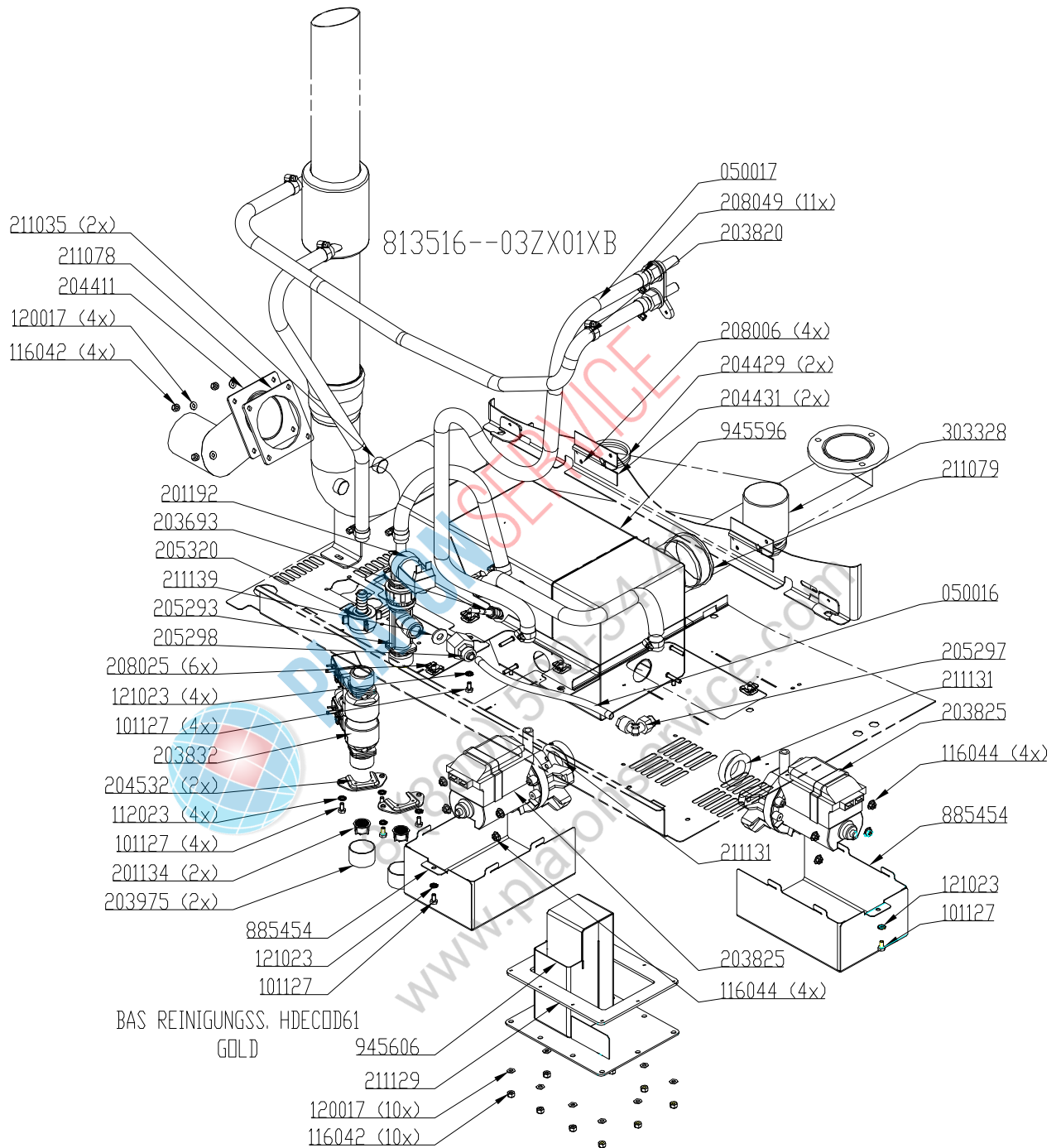

Note! Part number for 60Hz pump = #203826

## Chassis HD6.x Electric

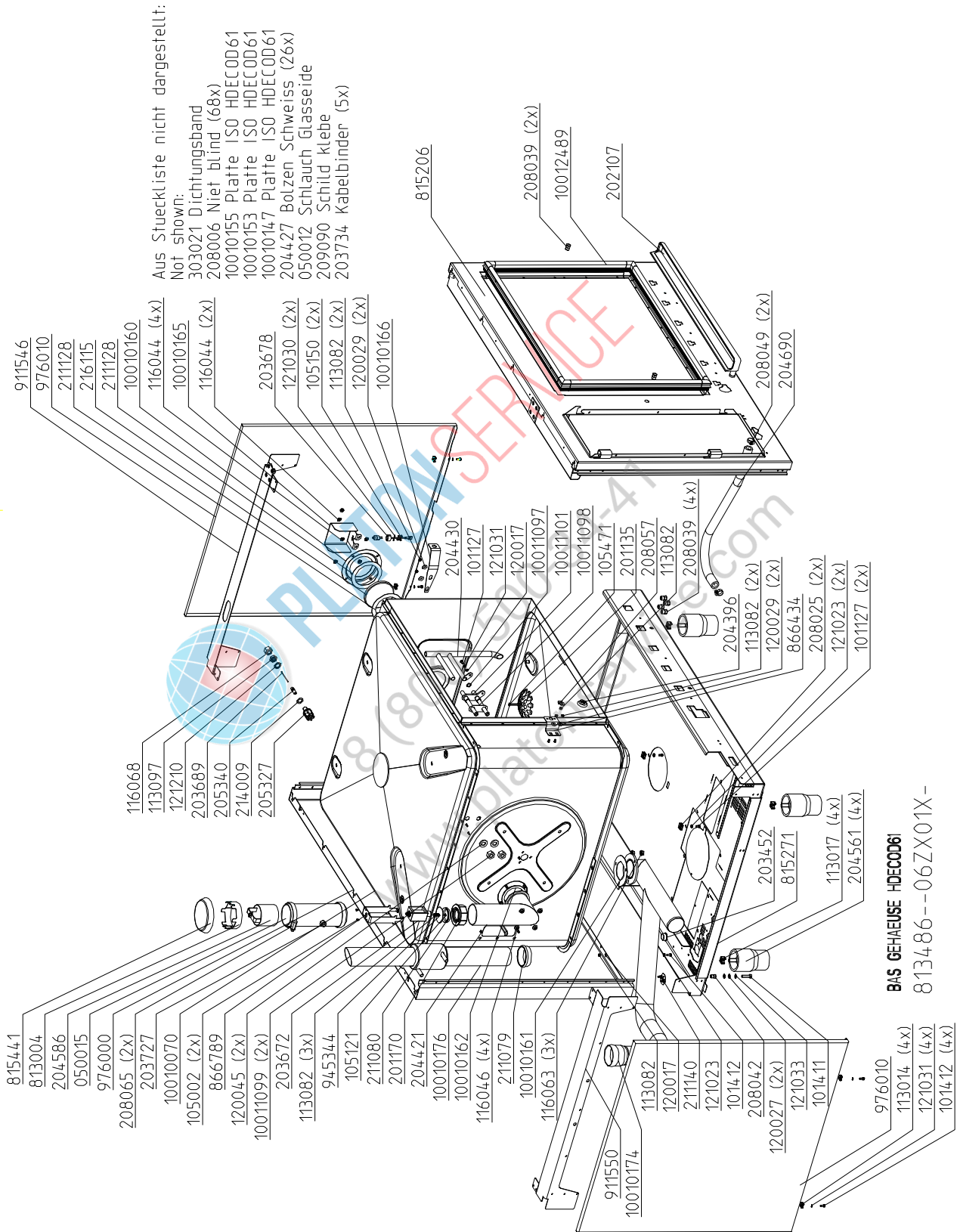

## Chassis HD10.x Electric

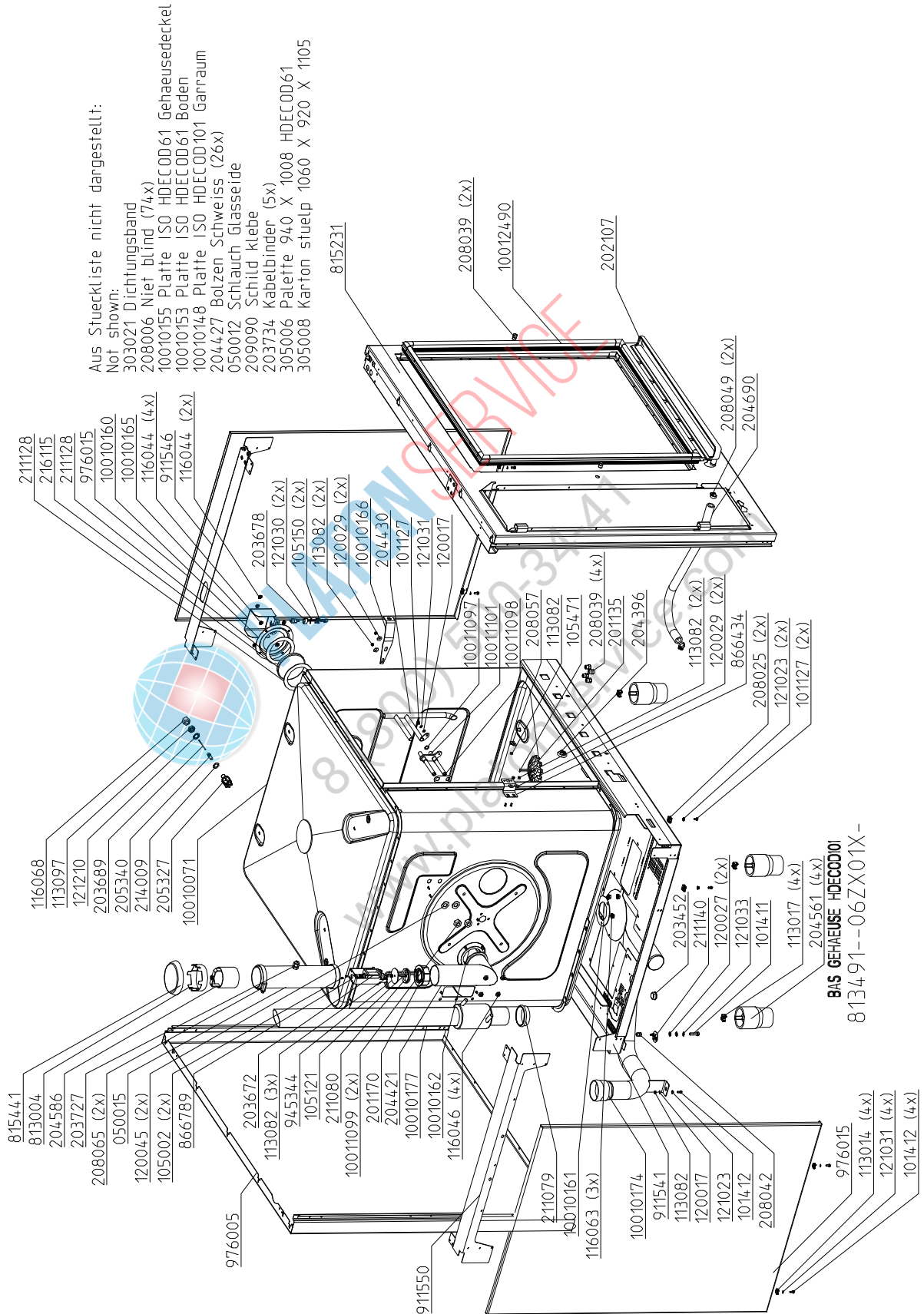

## Chassis HD6.x Gas

Aus Stueckliste nicht dargestellt:  
 Not shown:  
 303021 Dichtungsband  
 208006 Niet blind (74x)  
 10010155 Platte ISO HDEC0061 Gehaeusedeckel  
 10010153 Platte ISO HDEC0061 Boden  
 10010150 Platte ISO HDGC0061 Garraum  
 204427 Bolzen Schweiß (26x)  
 050012 Schlauch Glasserde  
 209090 Schild klebe  
 203734 Kabelbinder (5x)  
 305006 Palette 940 X 1080 HDEC0061  
 305008 Kanton stueelp 1060 X 920 X 1105

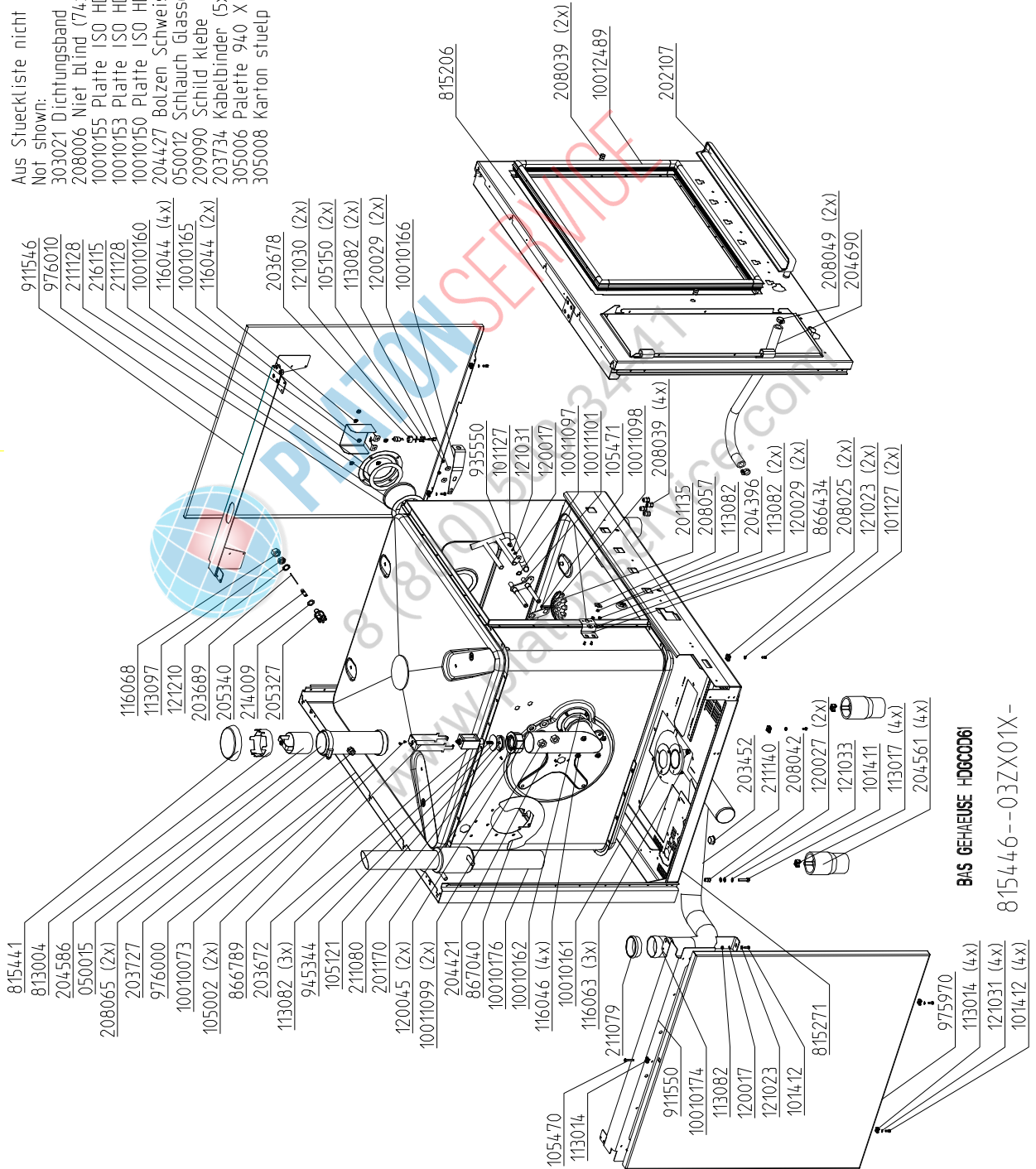



## Chassis HD10.x Gas

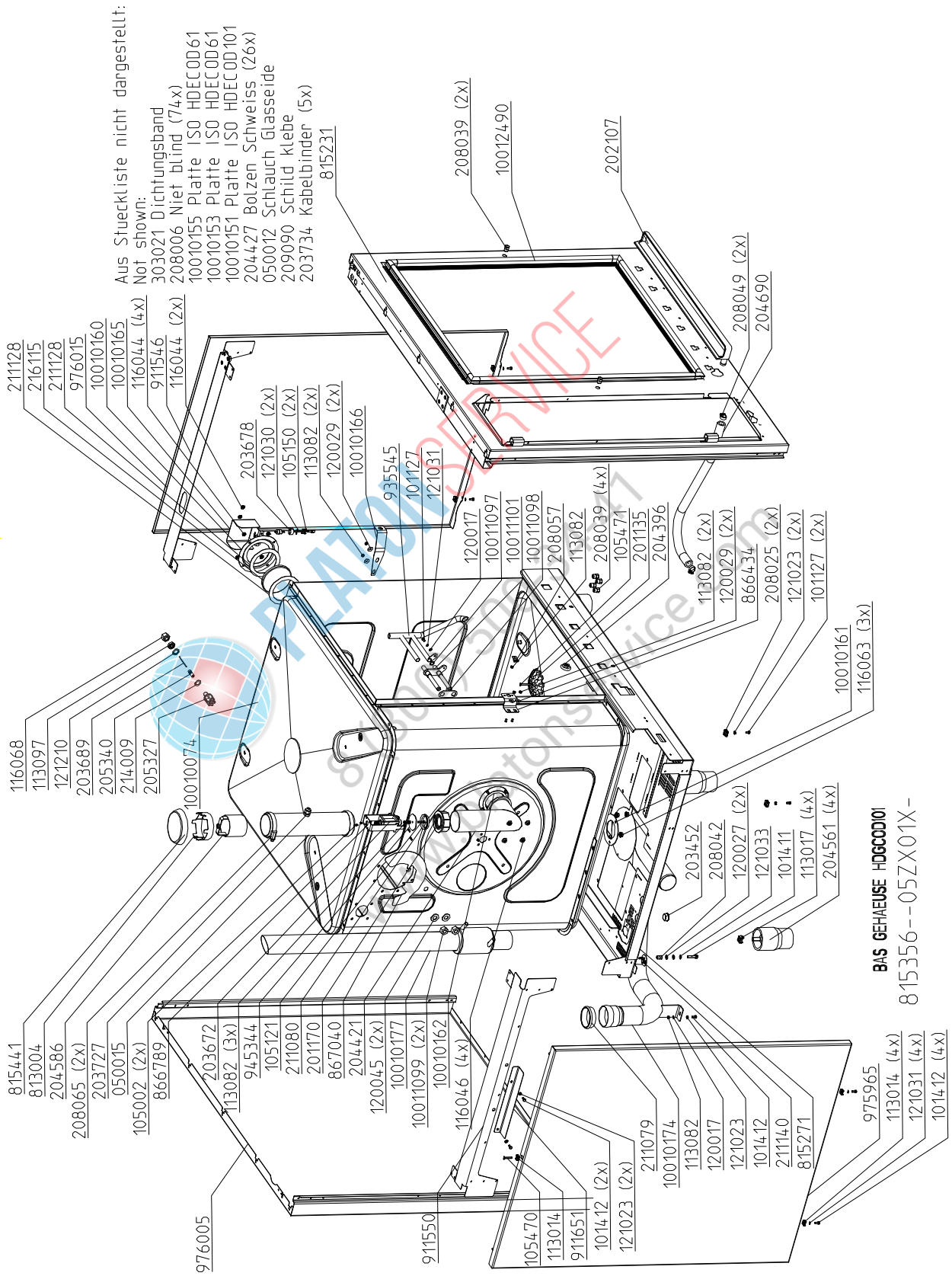

## Chassis door area HD6.x, right hinged (Electric)

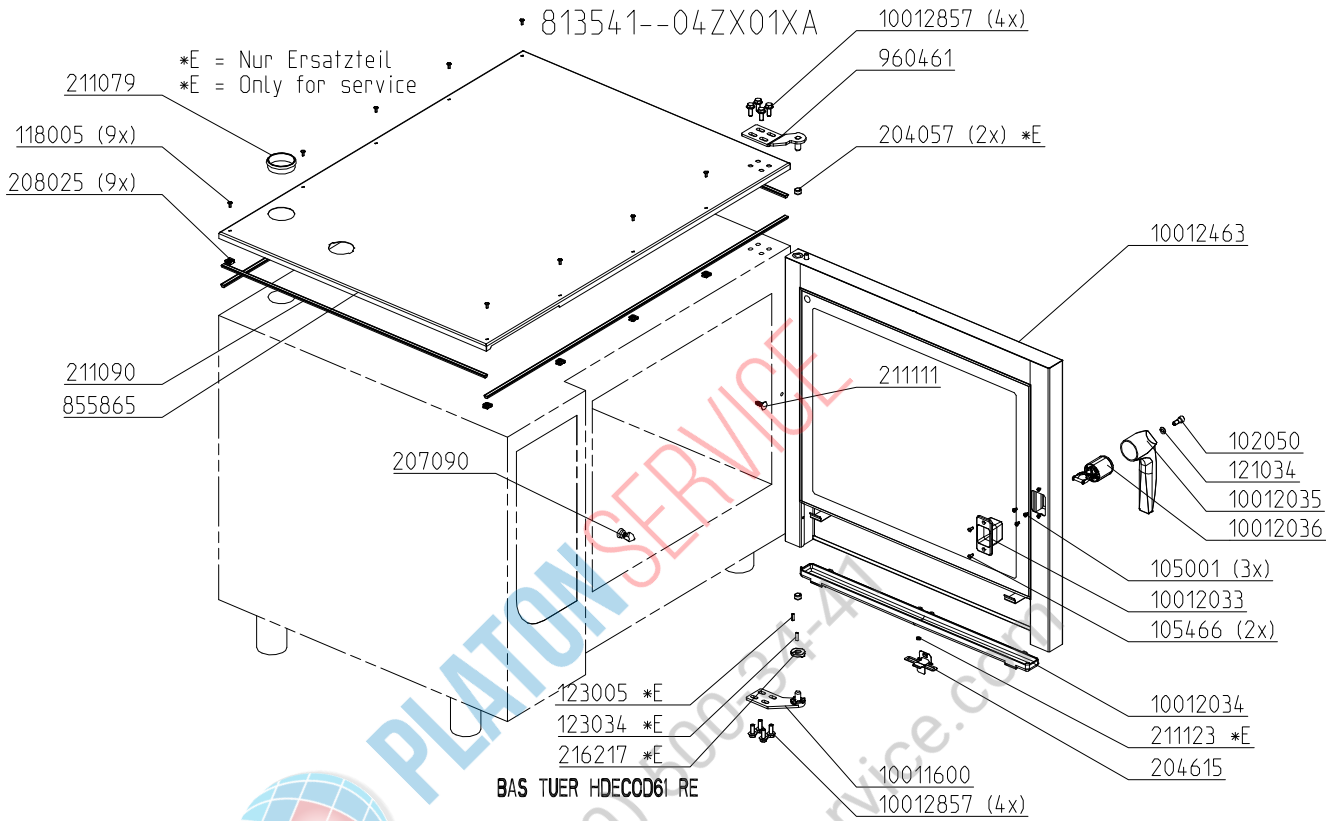

## Chassis door area HD6.x, left hinged (Electric)

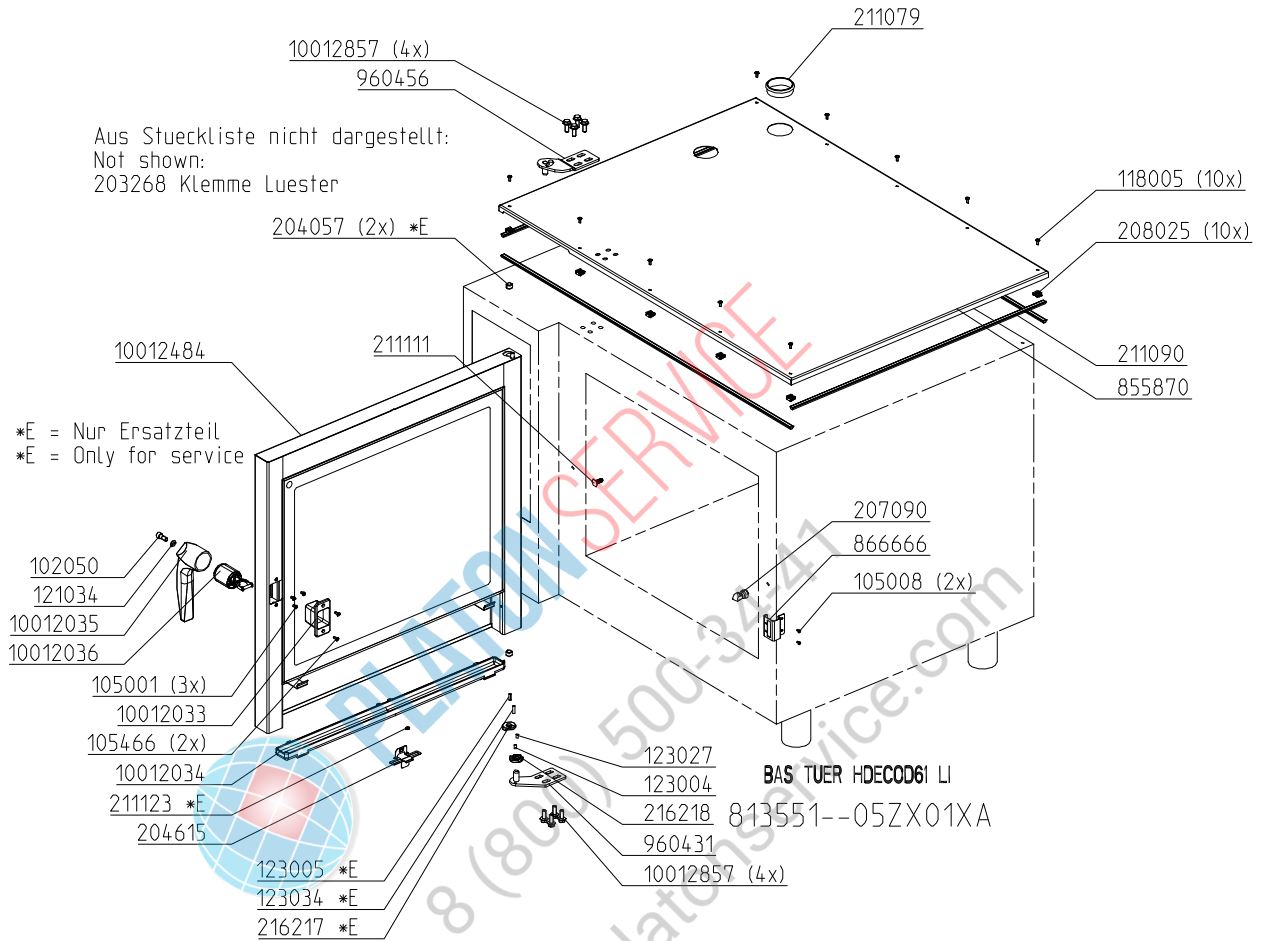



## Chassis door area HD10.x, right hinged (Electric)

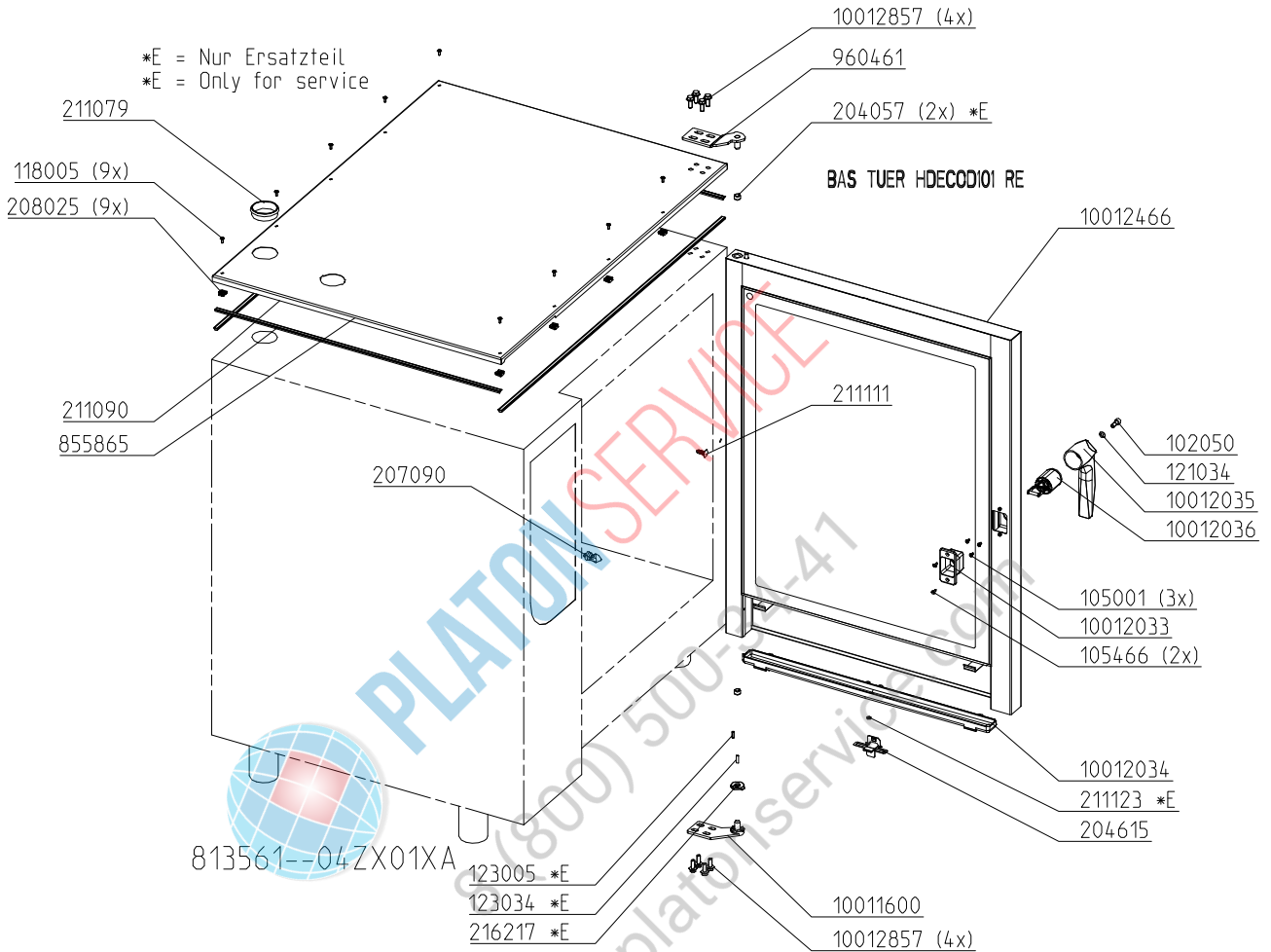

### Chassis door area HD10.x, left hinged (Electric)

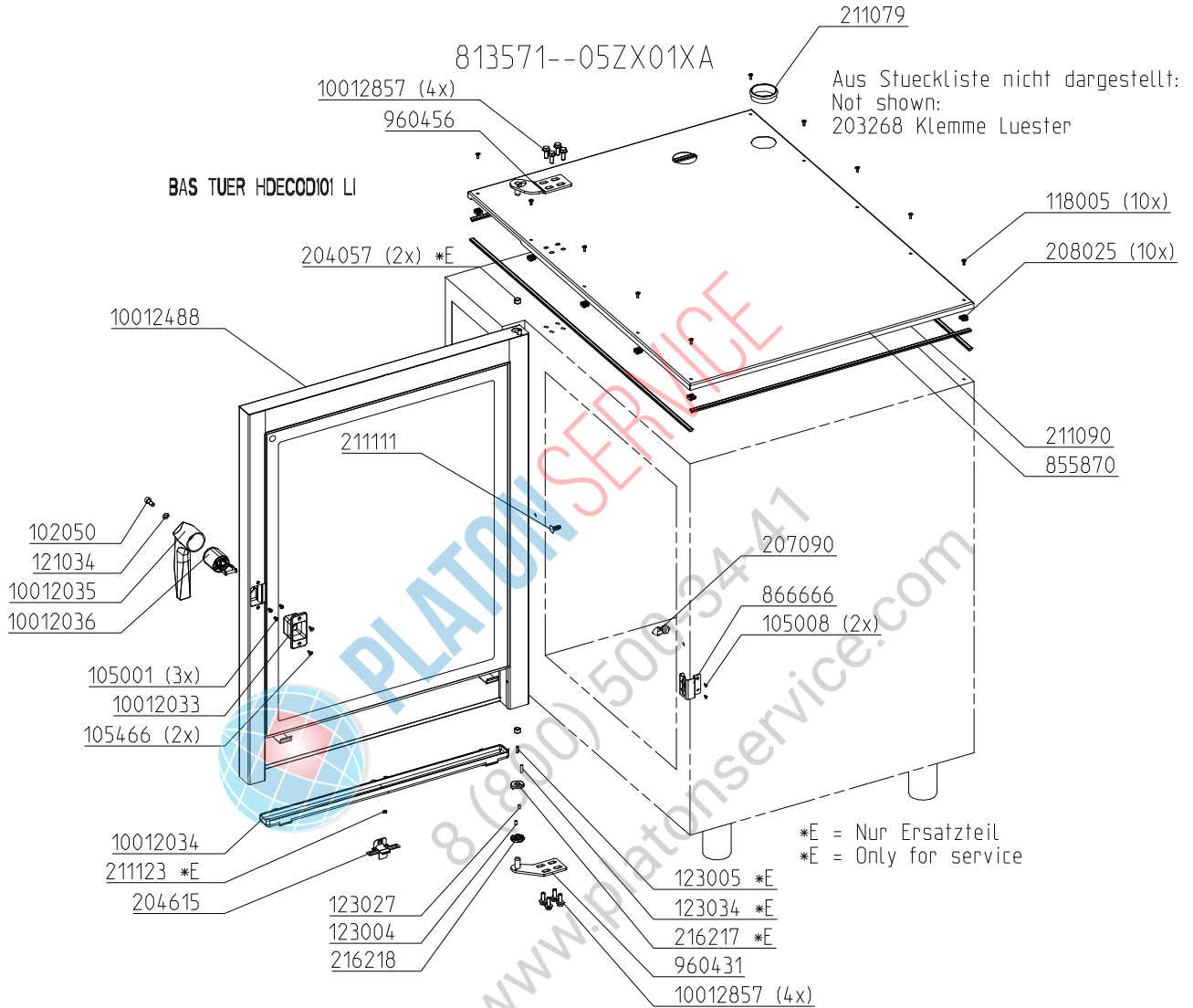

## Chassis door area HD6.x, right hinged (Gas)

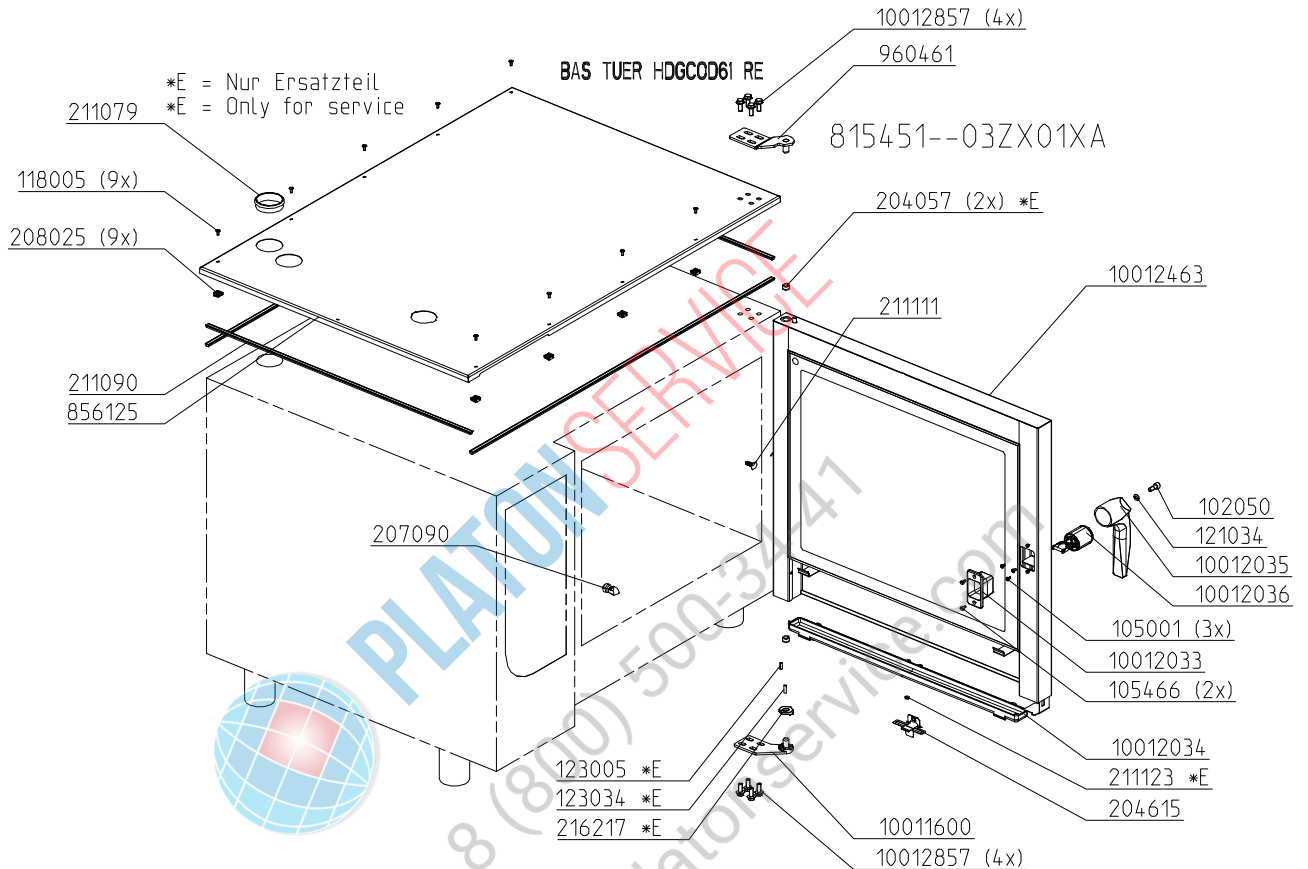

### Chassis door area HD6.x, left hinged (Gas)

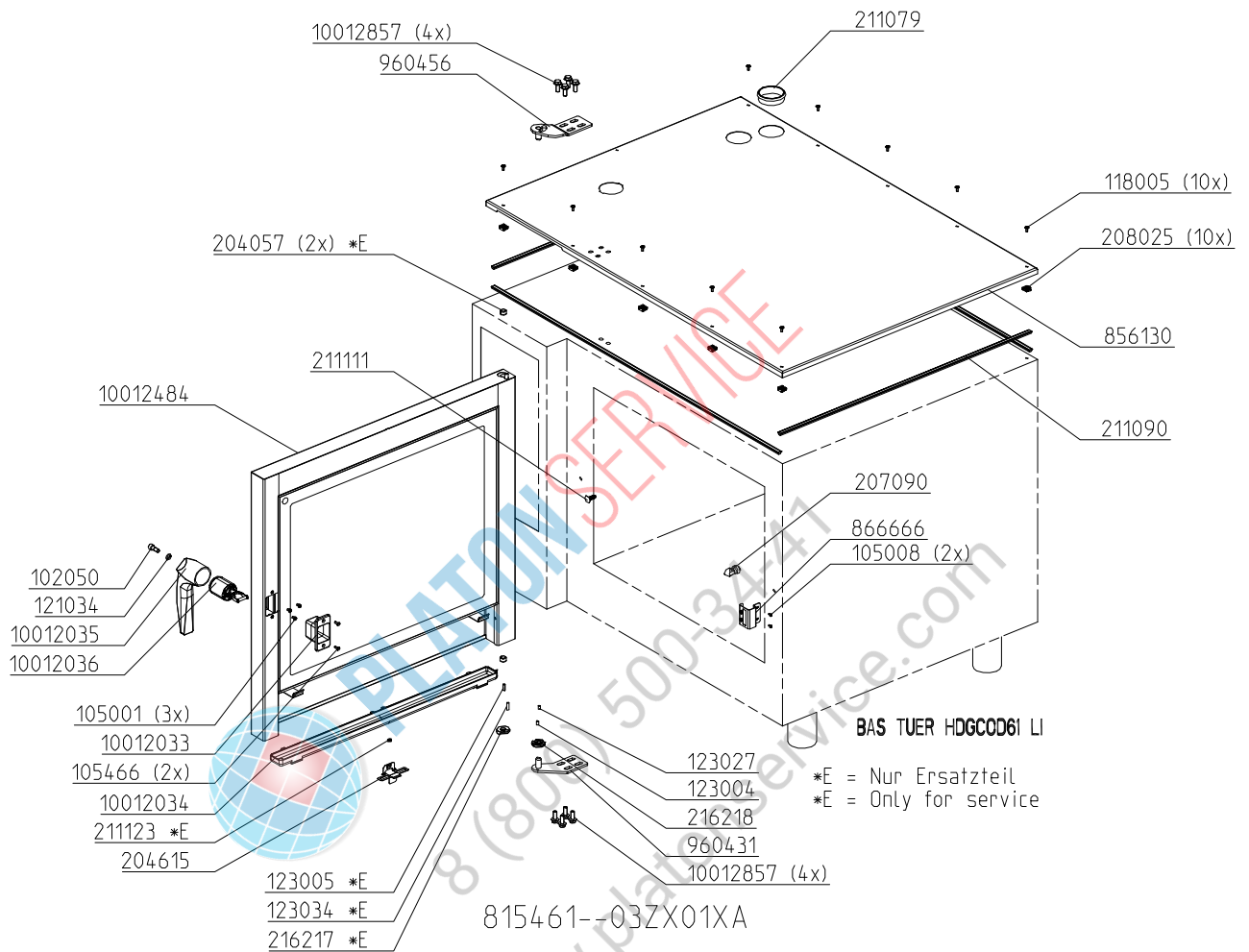

## Chassis door area HD10.x, right hinged (Gas)

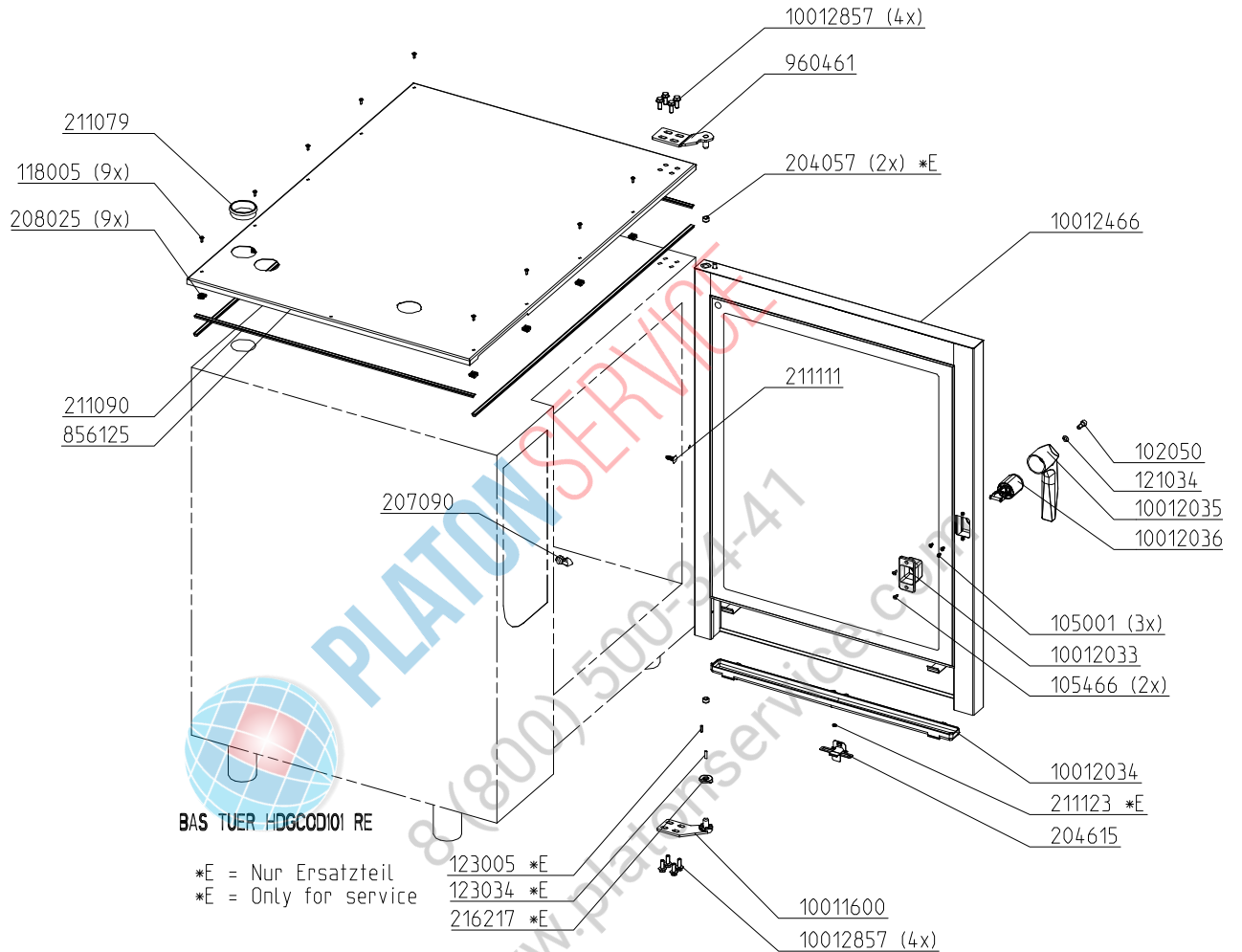

## Chassis door area HD10.x, left hinged (Gas)

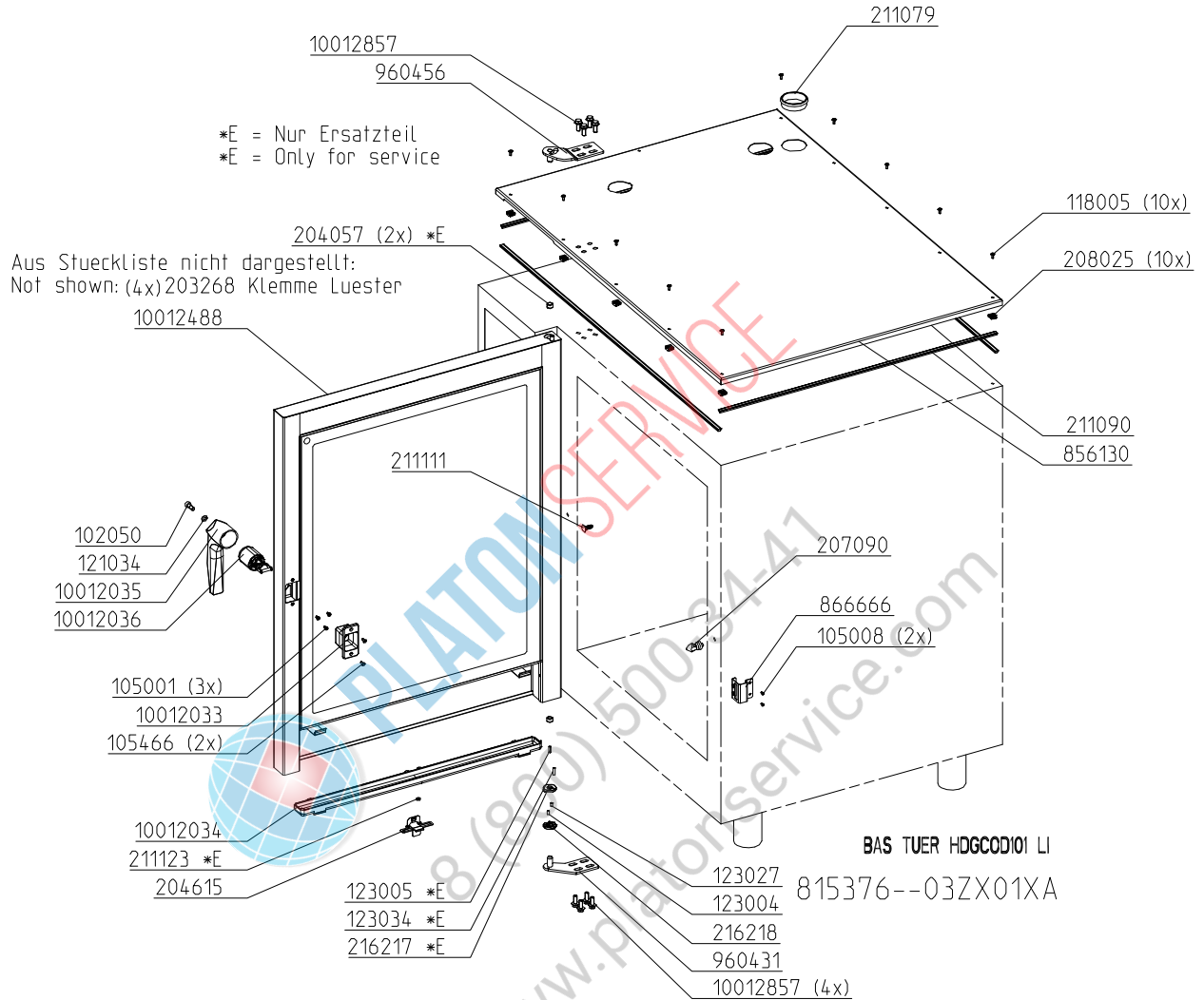

## Exploded drawings 20.x

Electric & Gas



PLATON SERVICE

8 (800) 500-34-41

[www.platonservice.com](http://www.platonservice.com)

## Front panel HD20.x Gold

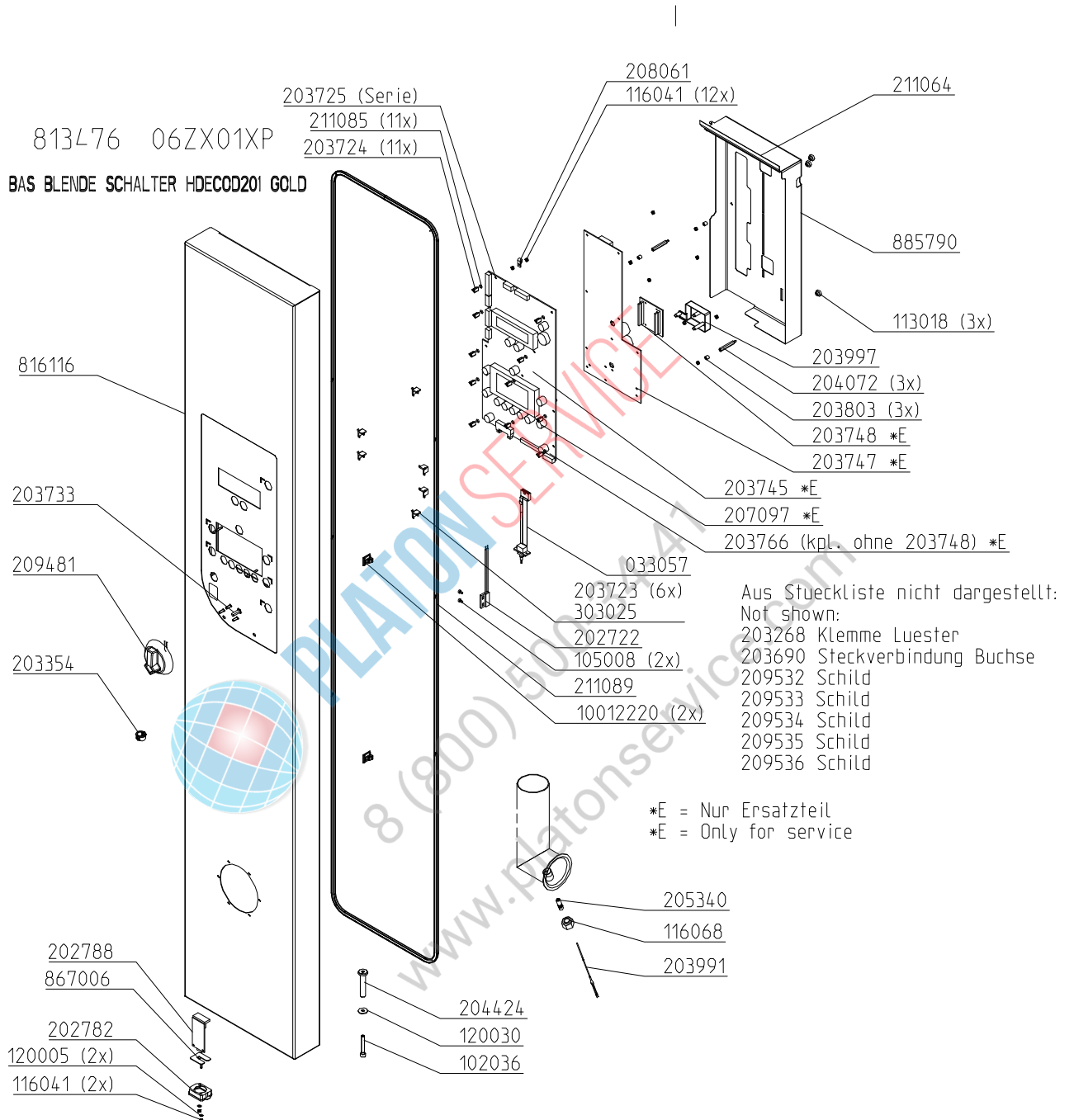



## Electric assembly 3NPEAC 400V HD20.1

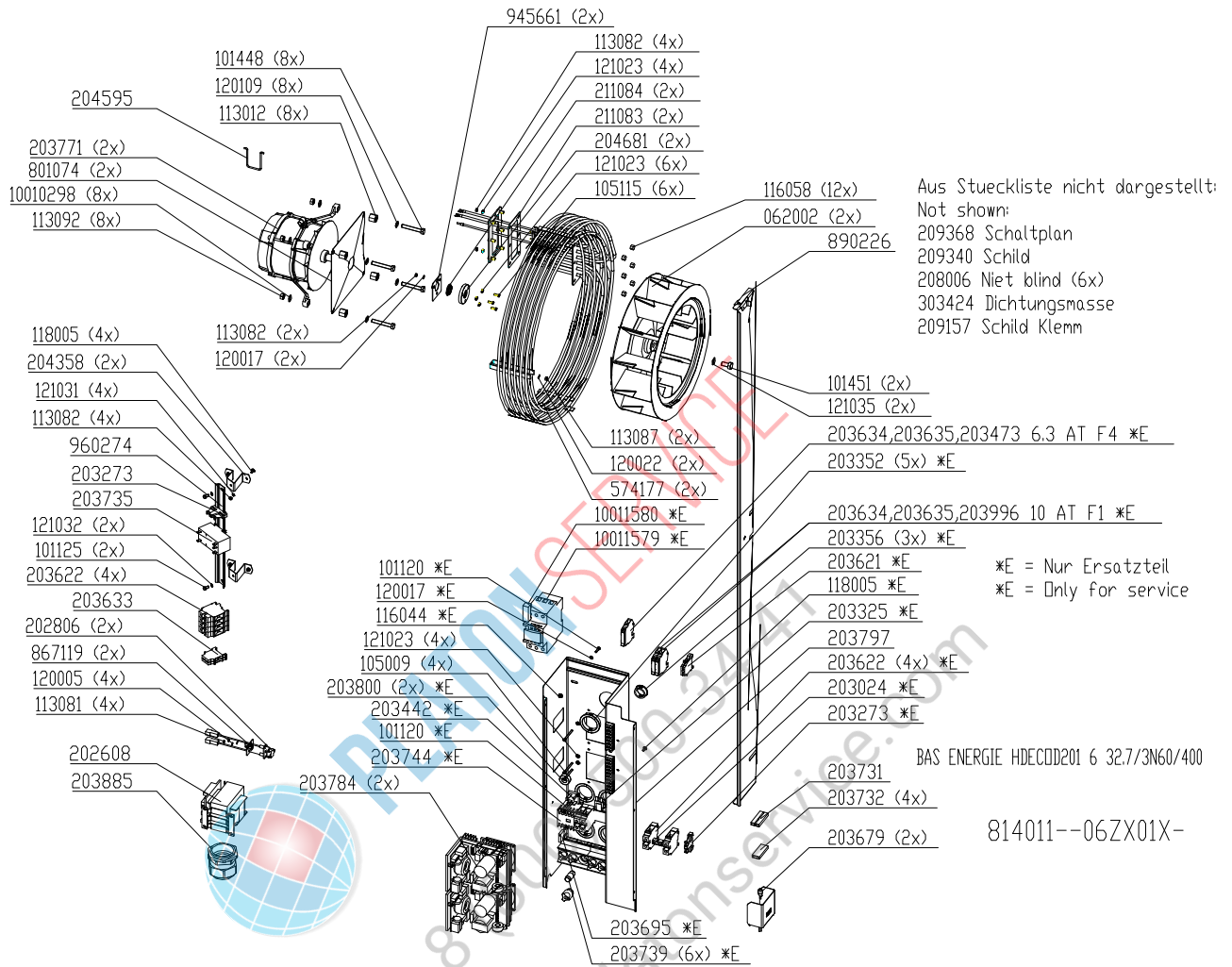

## Electric assembly 3NPEAC 400V HD20.2

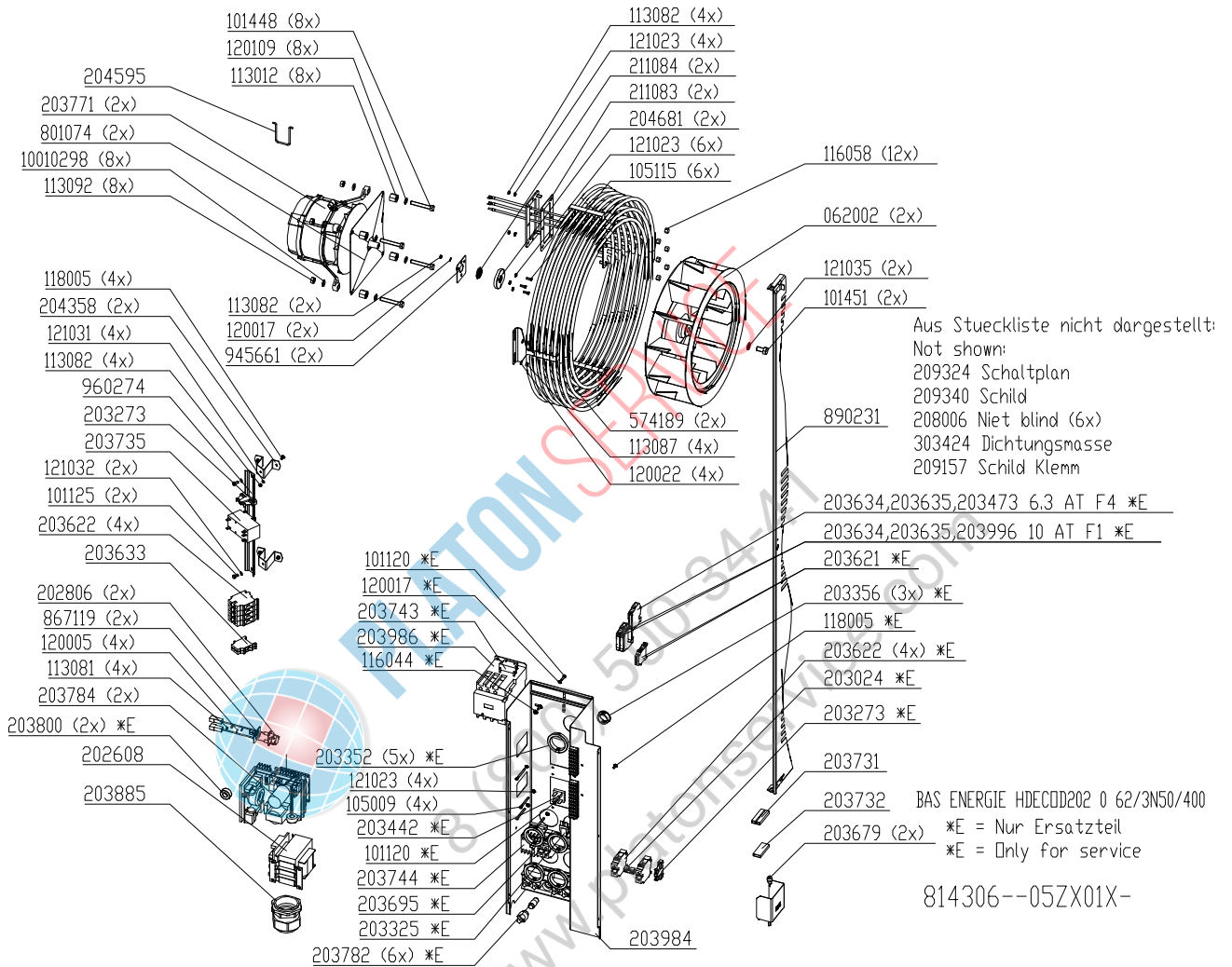

# Gas assembly HD20.1

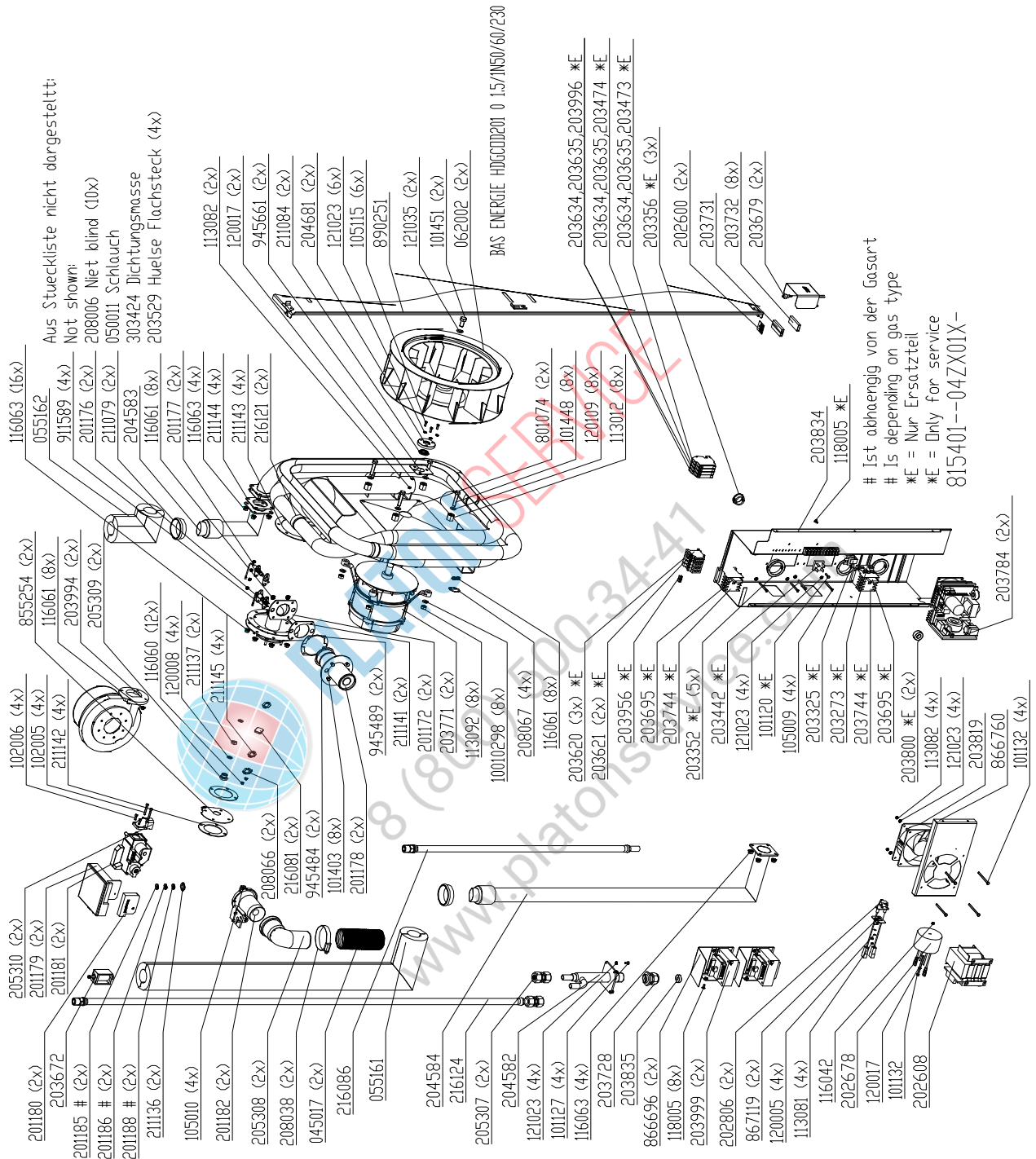

## Gas assembly HD20.2

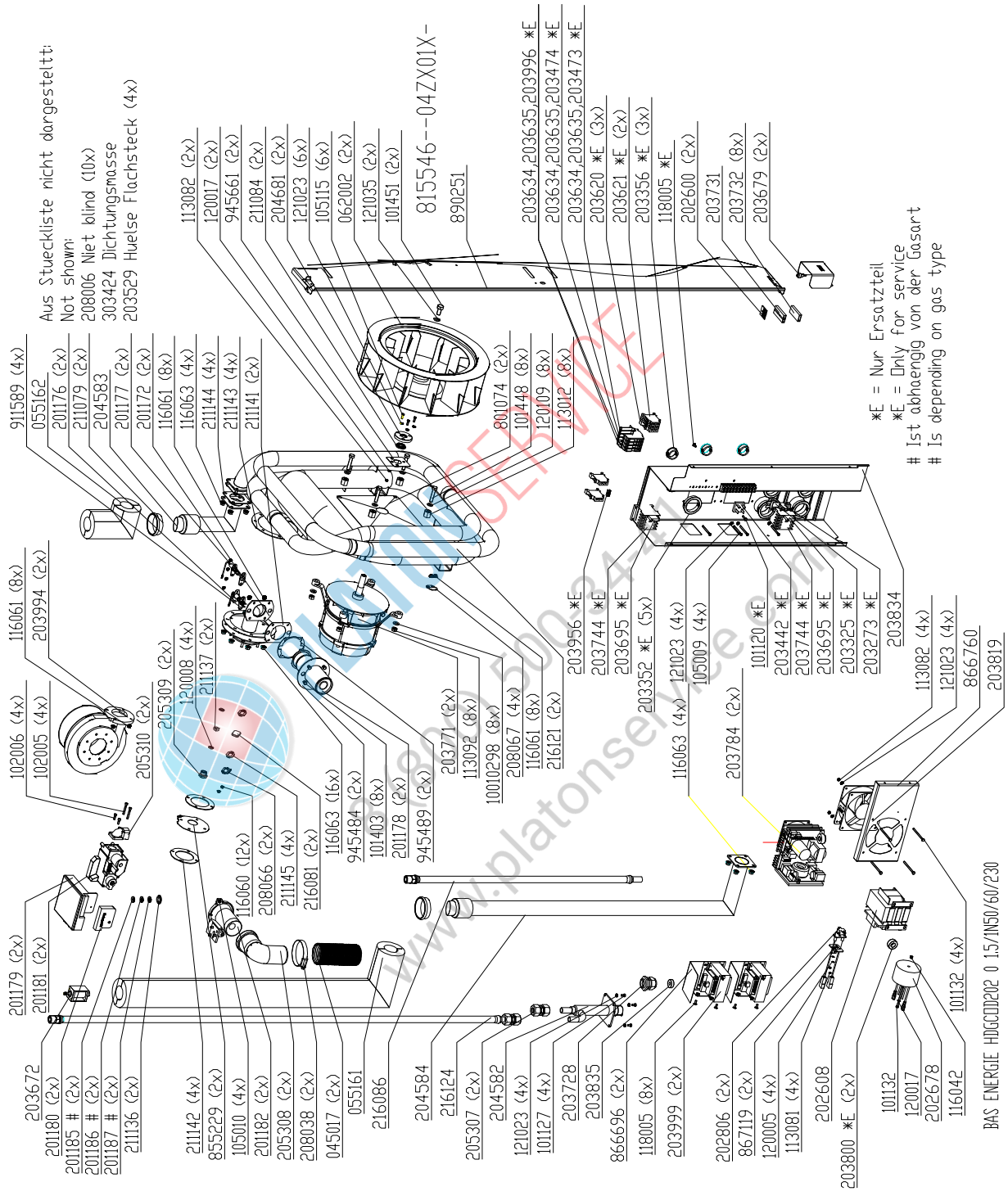

\*E = Nur Ersatzteil  
 \*E = Only for service  
 # Ist abhängig von der Gasart  
 # Is depending on gas type

BAS ENERGIE HDGCD202 0 1.5/1N50/60/230

### Core temperature probe HD20.x

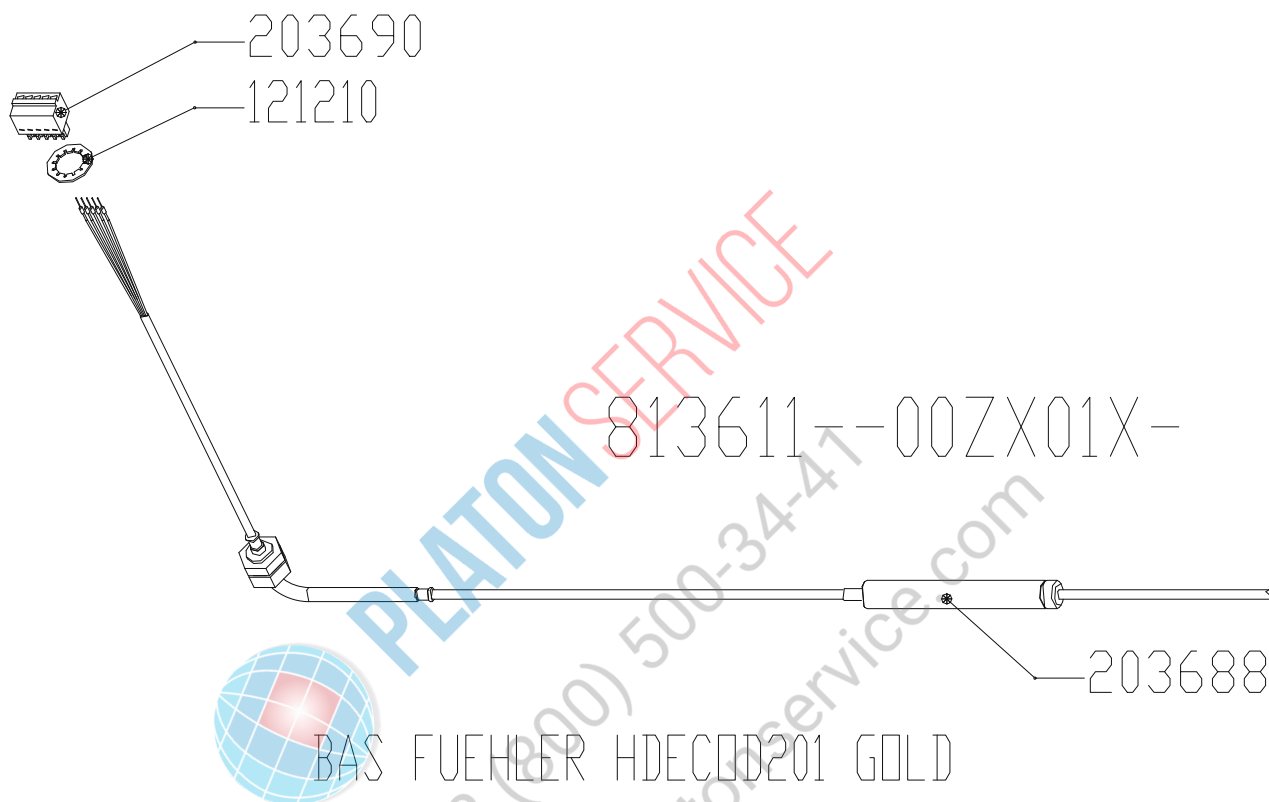

## Tube carrier box & handshower HD20.x (Electric)

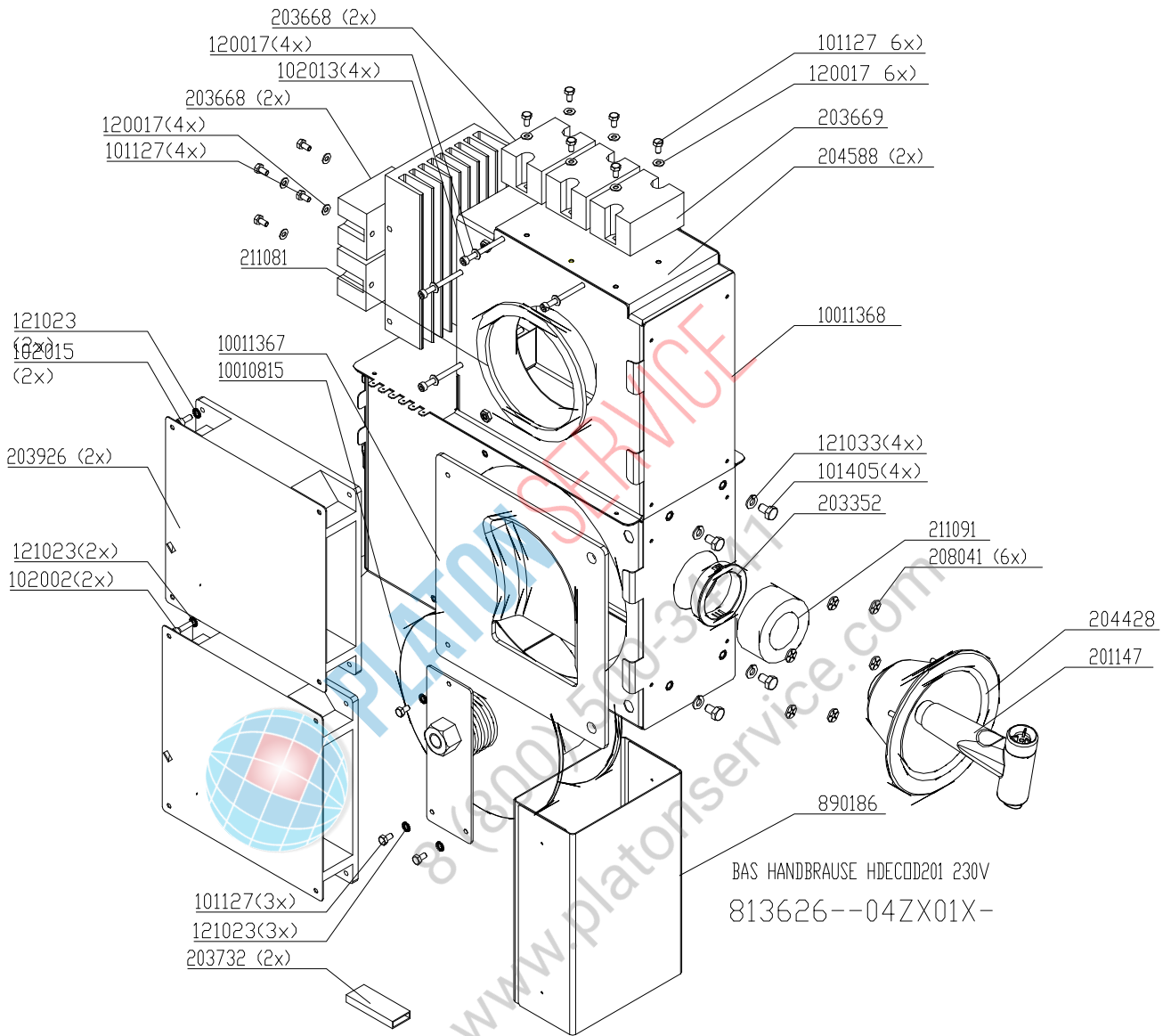

## Tube carrier box & handshower HD20.x Gas

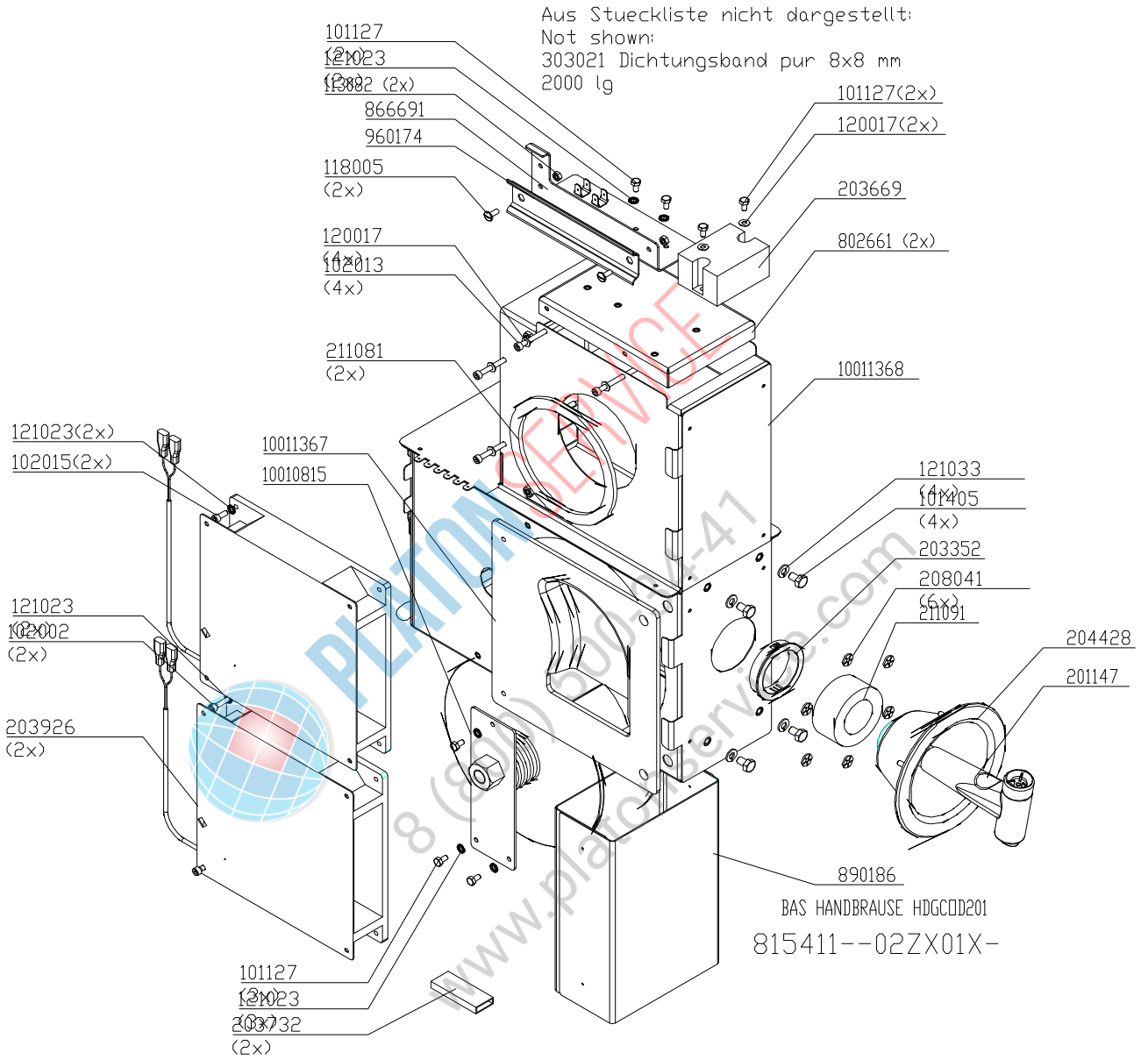



### Water assembly 50Hz HD20.x

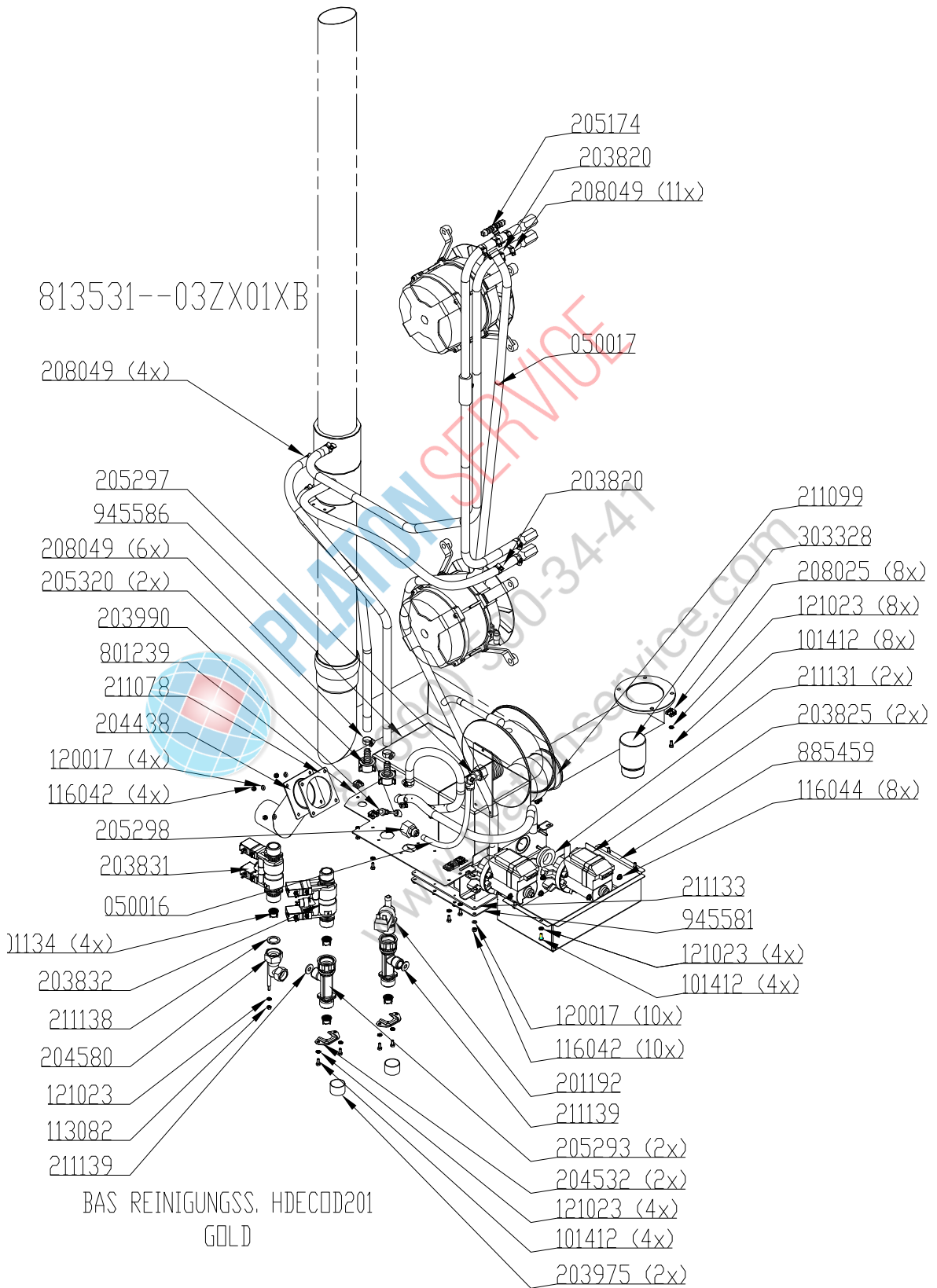

Note! Cleaning pumps 60 Hz = #203826



# Chassis HD20.x (Electric)

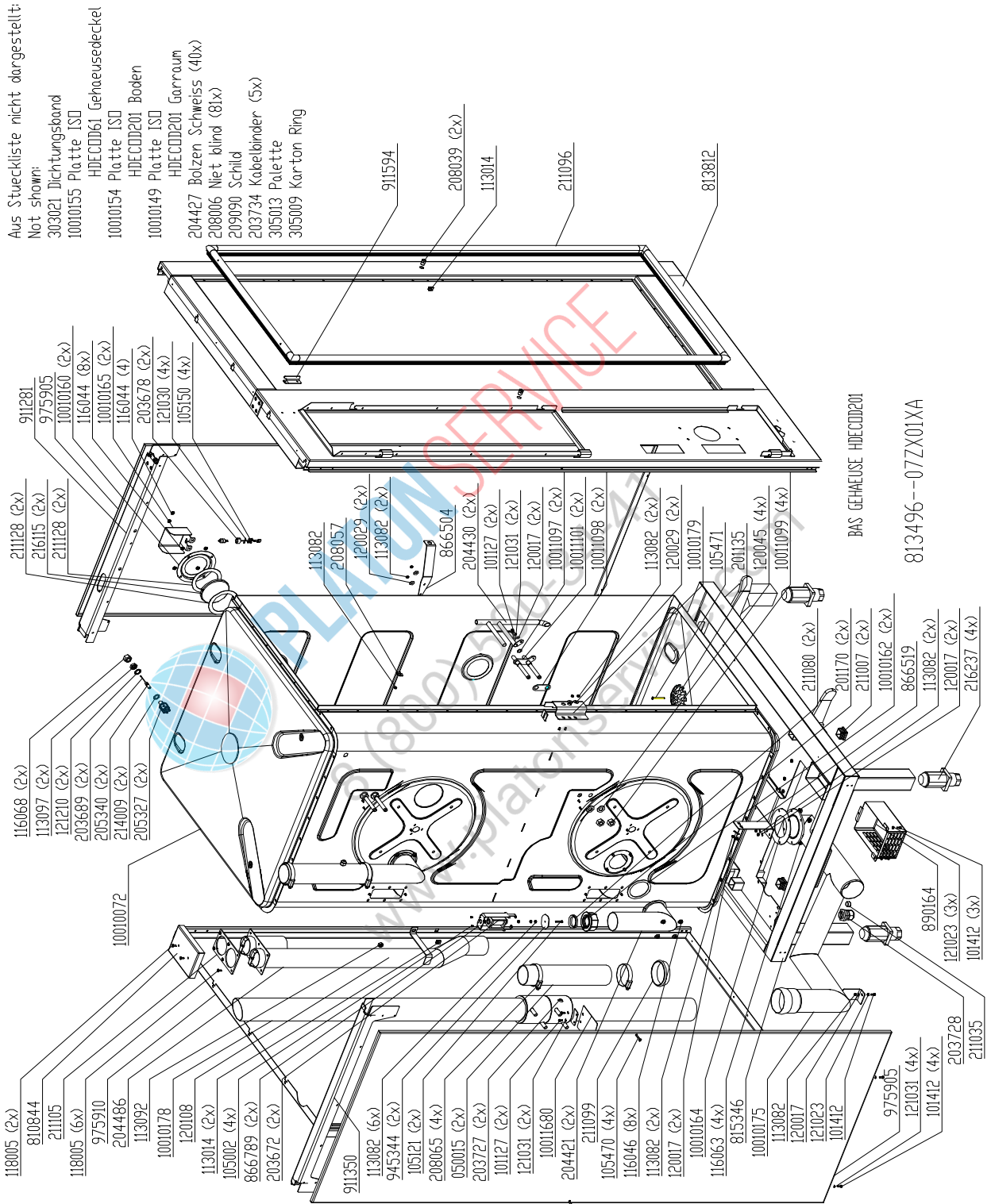

### Chassis HD20.x (Gas)

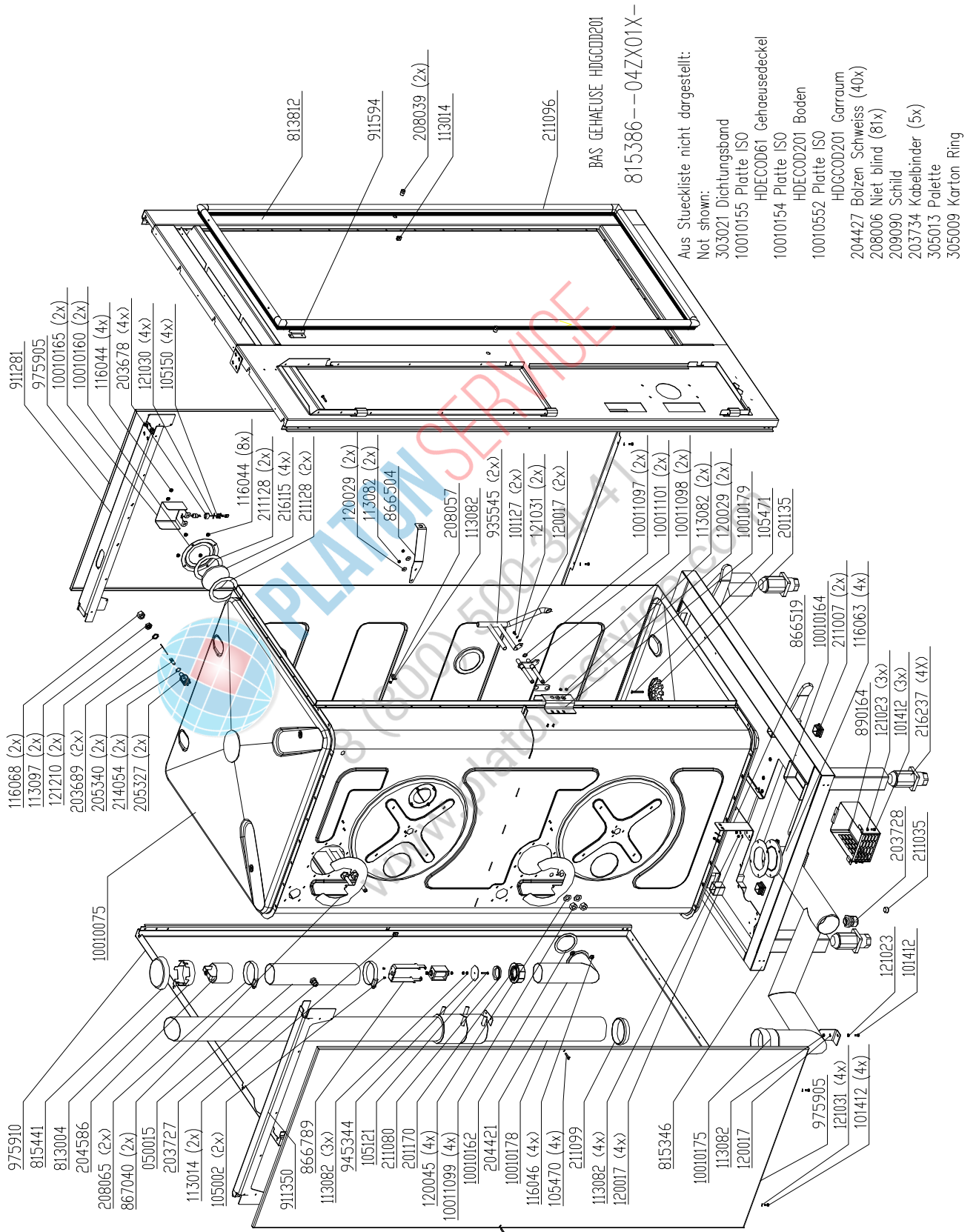

### Chassis door area HD20.x, right hinged (Electric)

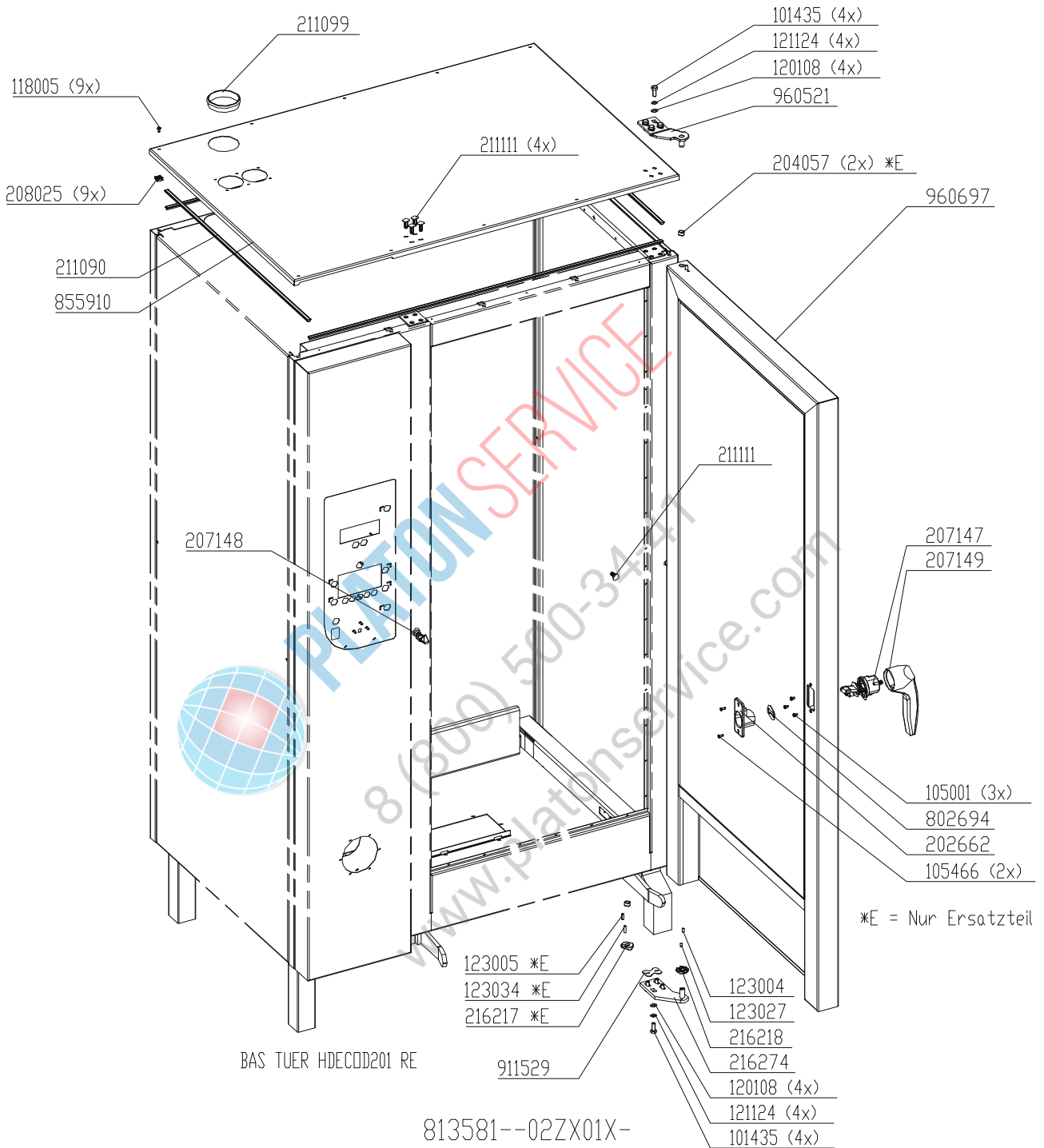

Bis S/N 09021515: #211104 Profildichtung Garraumtür (mit Pactan eingeklebt)  
 Ab S/N 09021516: Steckbare Profildichtung #211171

### Chassis door area HD20.x, left hand hinged (Electric)

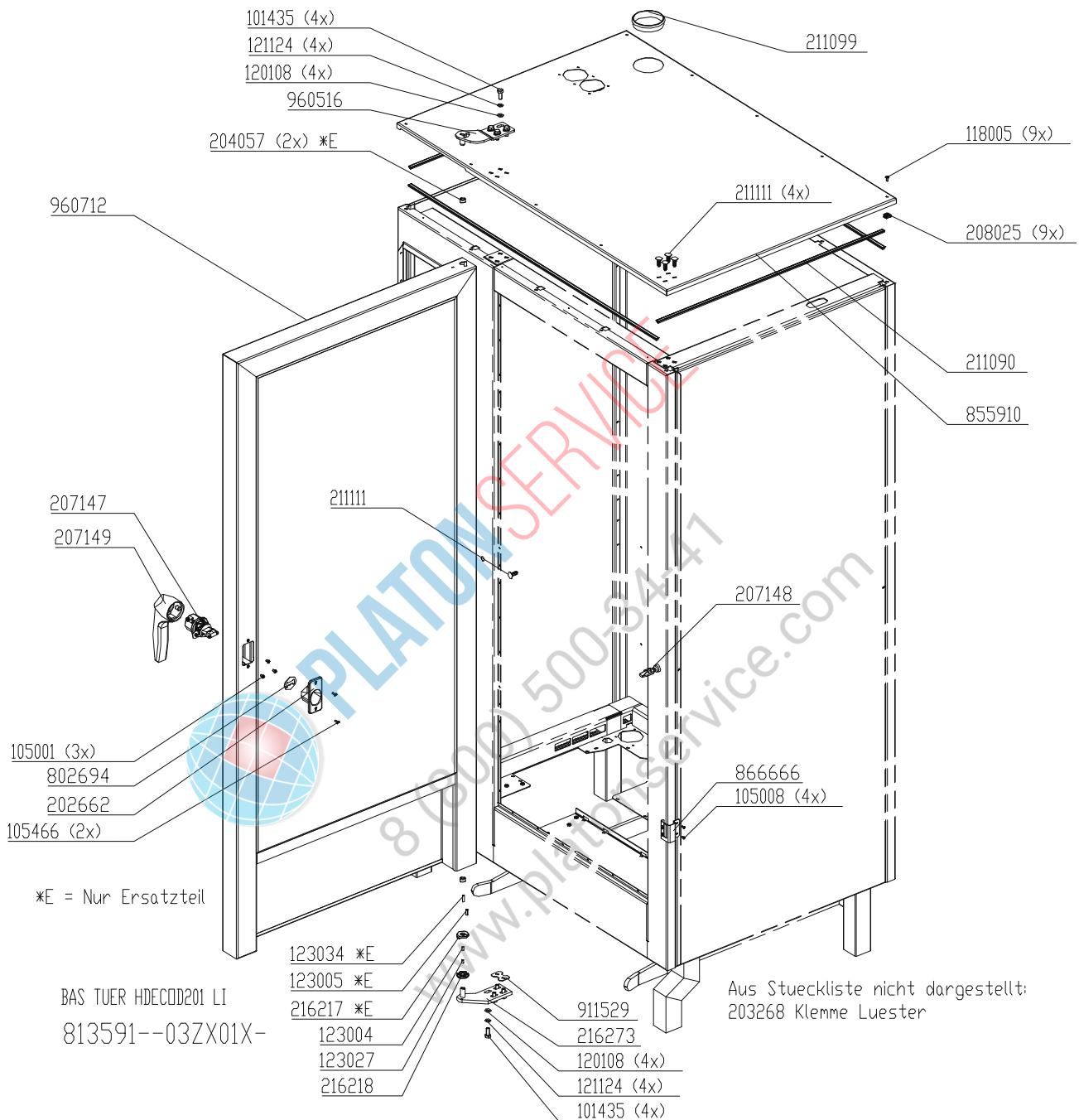

Bis S/N 09021515: #211104 Profildichtung Garraumtür (mit Pactan eingeklebt)  
Ab S/N 09021516: Steckbare Profildichtung #211171

### Chassis door area HD20.x, right hinged (Gas)

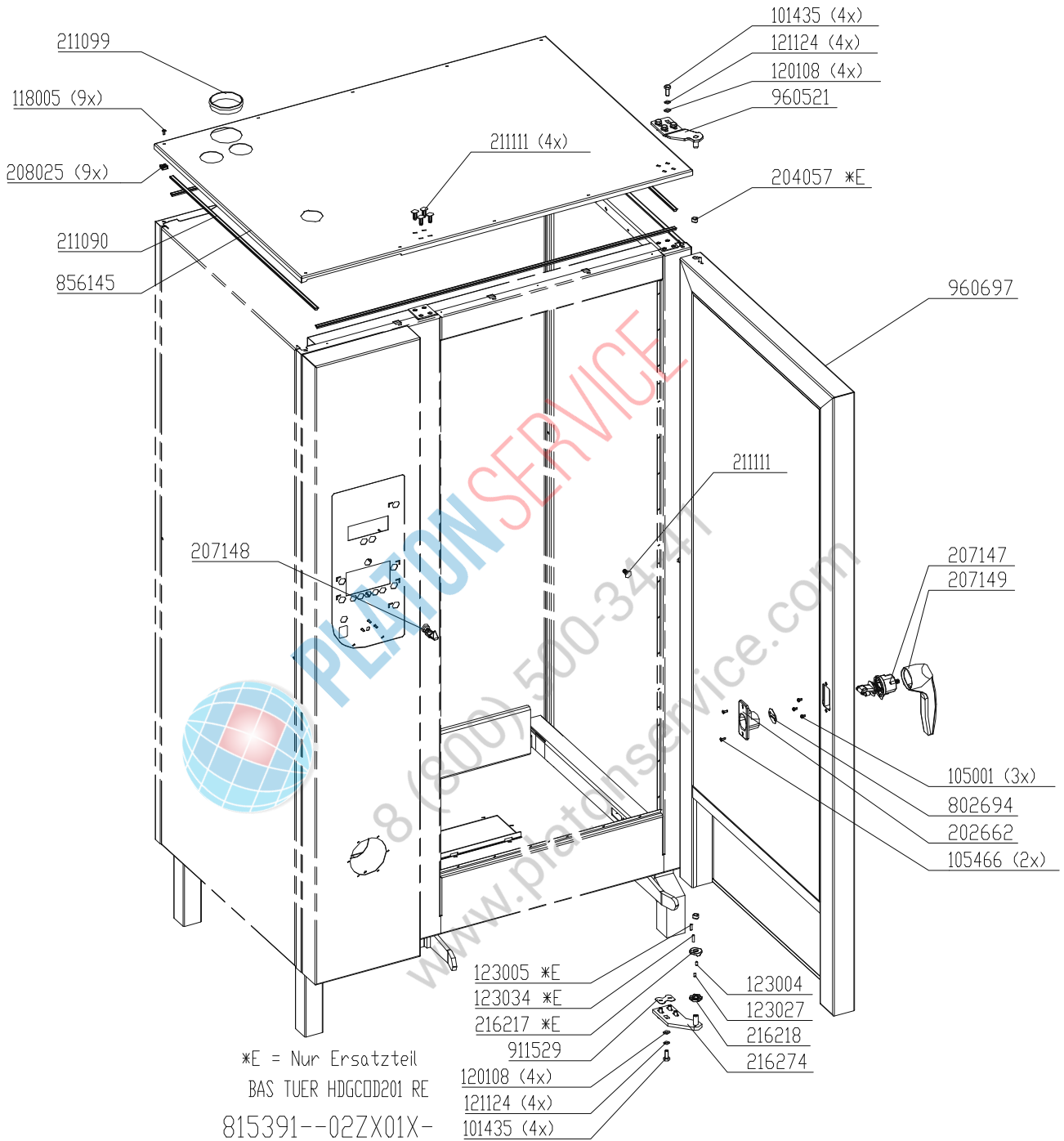

Door profile seal #211171

## Chassis door area HD20.x, left hand hinged

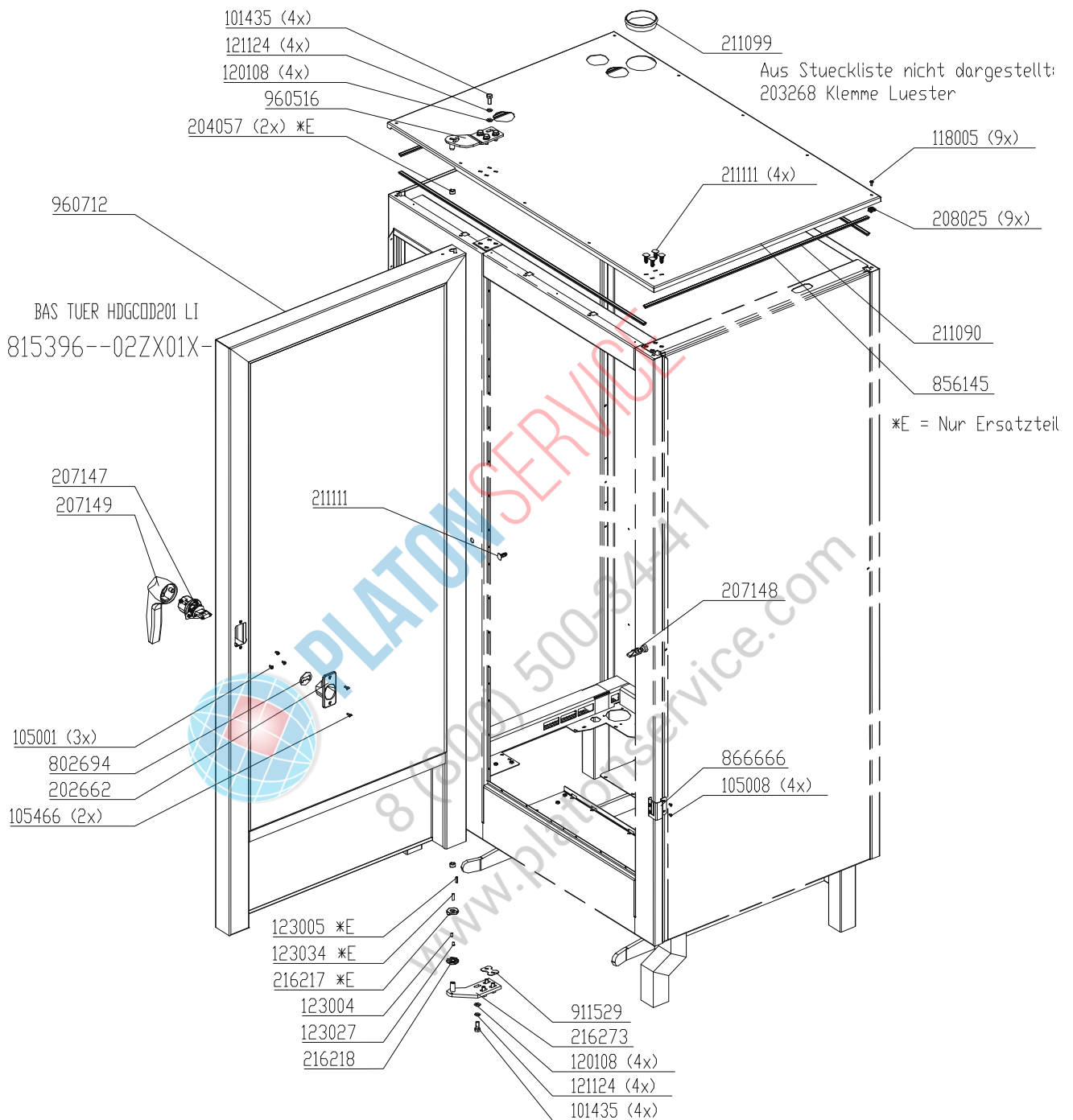

Door profile seal #211171

 **PLATON**SERVICE  
8 (800) 500-34-47  
[www.platonservice.com](http://www.platonservice.com)





MKN Maschinenfabrik  
Kurt Neubauer GmbH & Co  
Halberstädter Straße  
D-38300 Wolfenbüttel,  
Germany  
Tel: +49 (0) 53 31/ 89-0  
Fax: +49 (0) 53 31/ 89-280